



112 Murray Park Road Figtree NSW

3  1  3 

location | light | potential

Set on a sun-drenched 757sqm block surrounded by established gardens, this original brick home offers an exceptional opportunity to enter the tightly held Figtree market. Featuring three bedrooms and a well-proportioned floorplan, the home is comfortable today and ready for future updates, all within walking distance of local parks, walking tracks, schools and transport, and just a short drive to Figtree CBD; making it an ideal foundation for buyers looking to secure space, lifestyle and long-term potential.

what you will love...

[For full version visit the website](https://www.mcneice.com.au/8603365)

**Type** : House  
**Land Size** : 757 sqm  
**View** : <https://www.mcneice.com.au/8603365>



**Daniel Mulholland**  
02 4284 8536



**Emre Hasdiraz**  
02 4284 8536

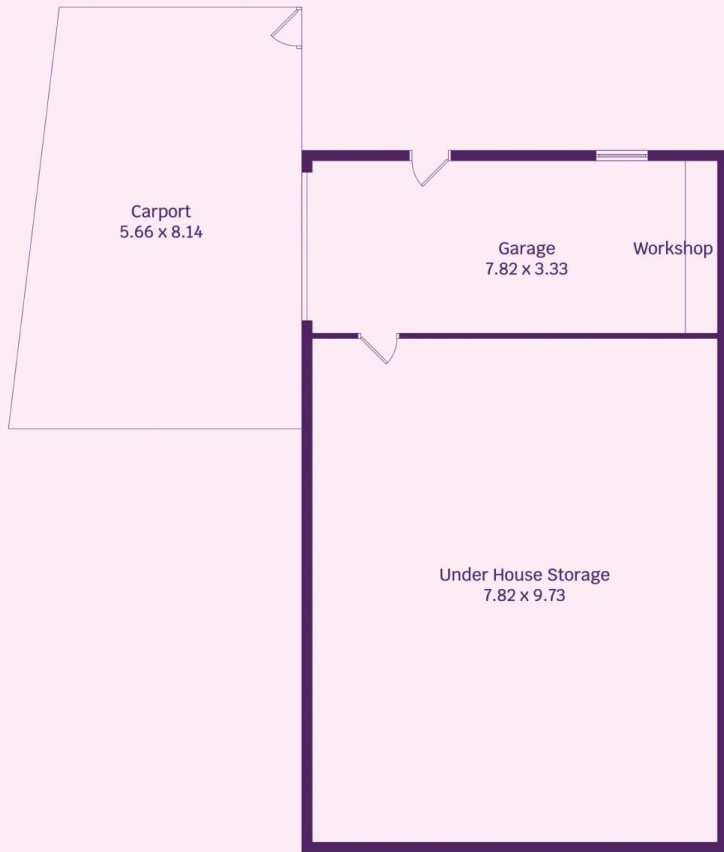

Lower Ground Floor

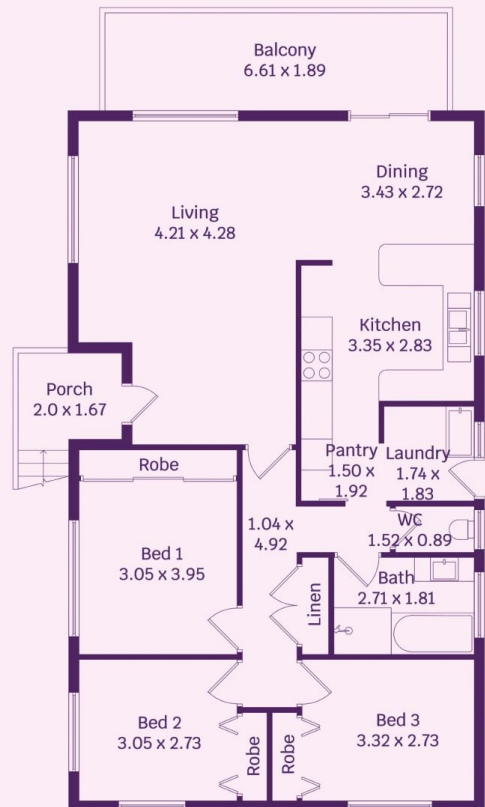

Ground Floor



Plans shown are for presentation purposes and are not part of any legal document. Dimensions are approximate