



## 12 Balfour Street Fairy Meadow NSW

2 1 3

location | potential | aspect

Perched on a generous 609sqm parcel with a sun-drenched north-facing yard, this character-filled home offers versatile potential and immediate scope to renovate, extend or explore future possibilities (STCA). Framed by leafy surrounds and capturing beautiful escarpment views, it presents a rare opportunity to personalise a classic residence with strong long-term growth appeal. Peacefully positioned yet highly convenient, it's moments from local schools, shops and popular patrolled beaches.

what you will love...

**Type** : House  
**Land Size** : 609 sqm  
**View** : <https://www.mcneice.com.au/8563385>



**Daniel Mulholland**  
02 4284 8536



**Emre Hasdiraz**  
02 4284 8536

[For full version visit the website](https://www.mcneice.com.au)

12 Balfour Street, Fairy Meadow

mcneice ✕

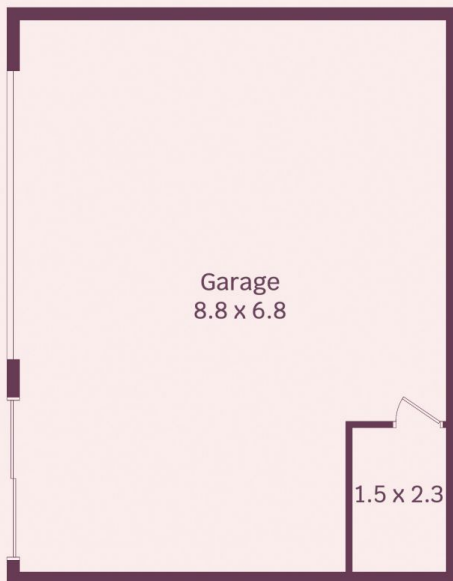
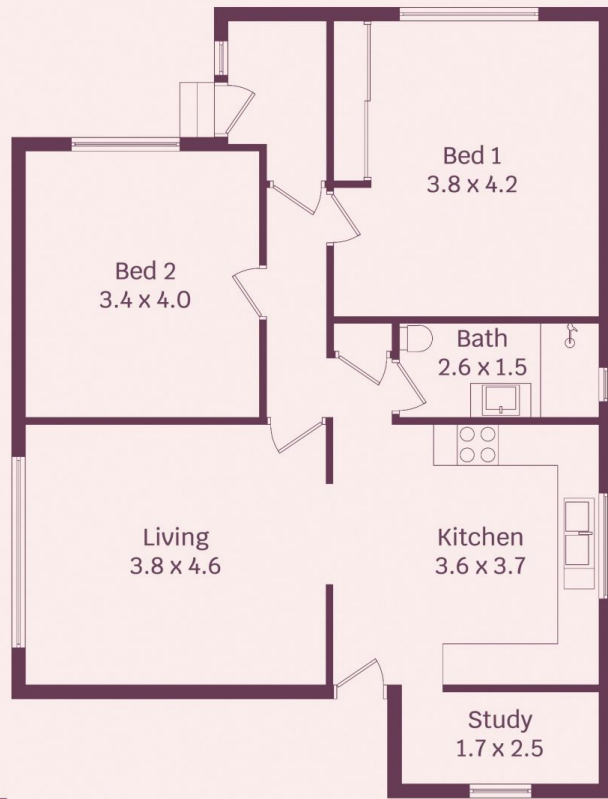

Not In Position



HOUSE INTERNAL AREA 87m<sup>2</sup>

HOUSE OVERALL AREA 154m<sup>2</sup>

Plans shown are for presentation purposes and are not part of any legal document.

Dimensions are approximate