



## 8 Silkwood Road Woonona NSW

3 2 2

peaceful | community | lifestyle

Situated in a peaceful neighborhood, this beautifully presented single-level home is perfect for families and downsizers alike. Featuring a flexible and spacious floor plan, freshly updated interiors, and a convenient location within walking distance to shops, schools, and public transport.

what you will love?

- > spacious open-plan living, dining and kitchen areas flowing to alfresco spaces
- > updated kitchen with gas cooking, wall oven and

[For full version visit the website](https://www.mcneice.com.au)

**Type** : House  
**Price** : \$ 1,270,000  
**Land Size** : 349 sqm  
**View** : <https://www.mcneice.com.au/8560962>



**Joshua De Smuszko**  
02 4284 8536



**Troy McNeice**  
02 4284 8536

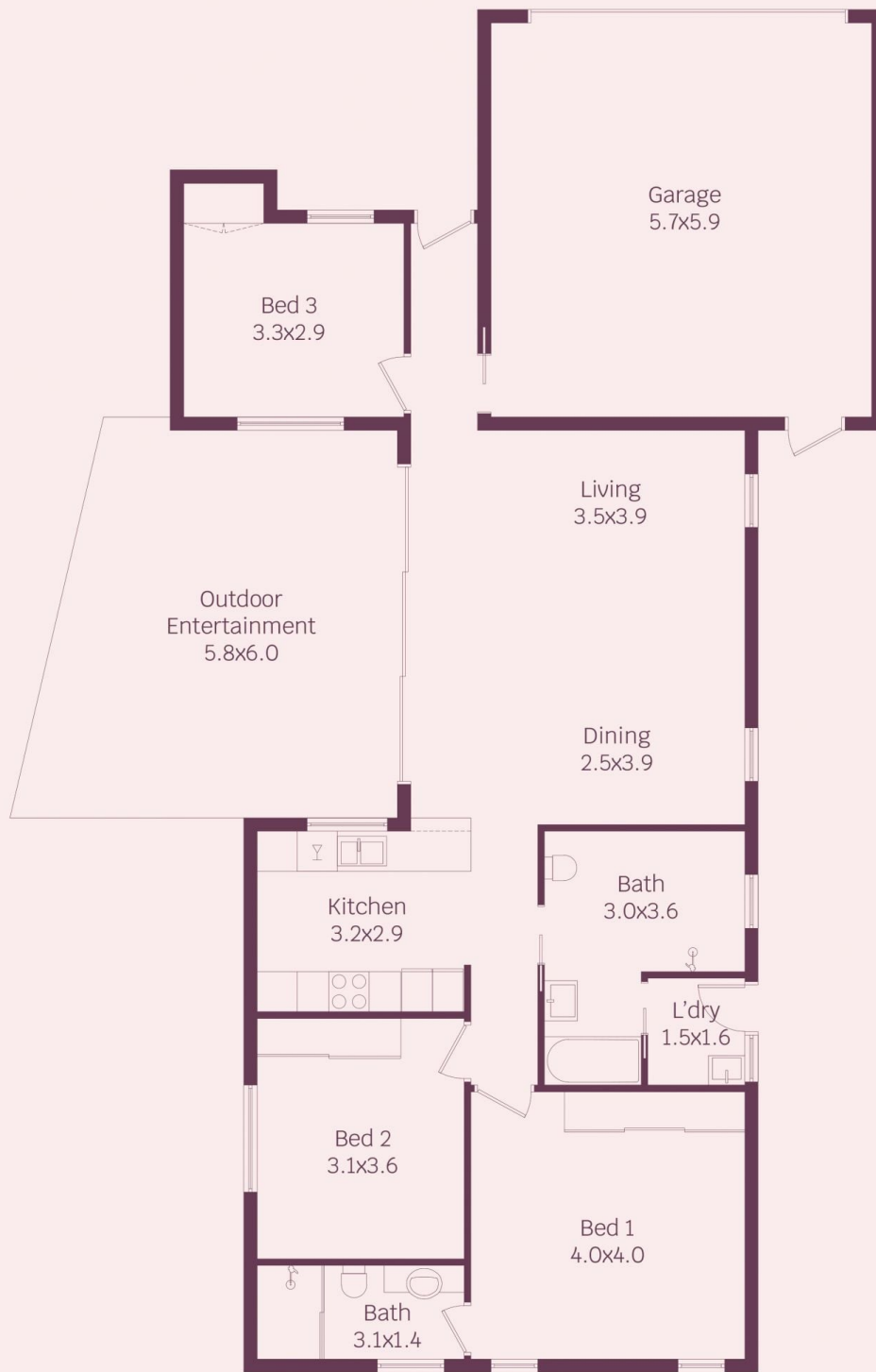

HOUSE INTERNAL AREA 148m<sup>2</sup>

HOUSE OVERALL AREA 180m<sup>2</sup>

Plans shown are for presentation purposes and are not part of any legal document.

Dimensions are approximate