



17/12 Waterloo Street Bulli NSW

3 1 1

affordable | space | location

Situated in an ever-popular complex within strolling distance to Bulli beach. With north to rear orientation and a generous courtyard, this is the perfect affordable entry into east Bulli. Only minutes to major shopping and cafes.

what you will love?

- > open living and dining area opening onto rear courtyard and yard space
- > neat and tidy kitchen with ample bench and cupboard space
- > floating floors downstairs and carpets upstairs

[For full version visit the website](https://www.mcneice.com.au/8488332)

Type : Townhouse

View : <https://www.mcneice.com.au/8488332>



Hilary Moy
02 4284 8536



Erin McPhillips
02 4284 8536

17/12 WATERLOO STREET, BULLI

+ molenaar
mcneice

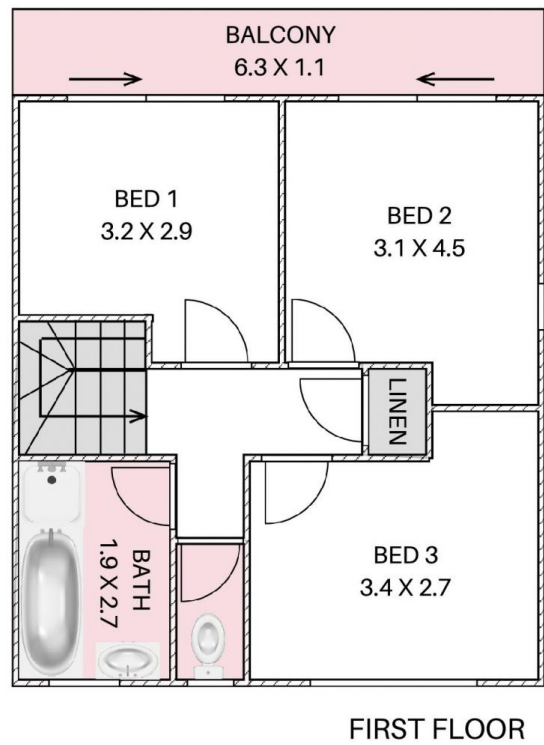
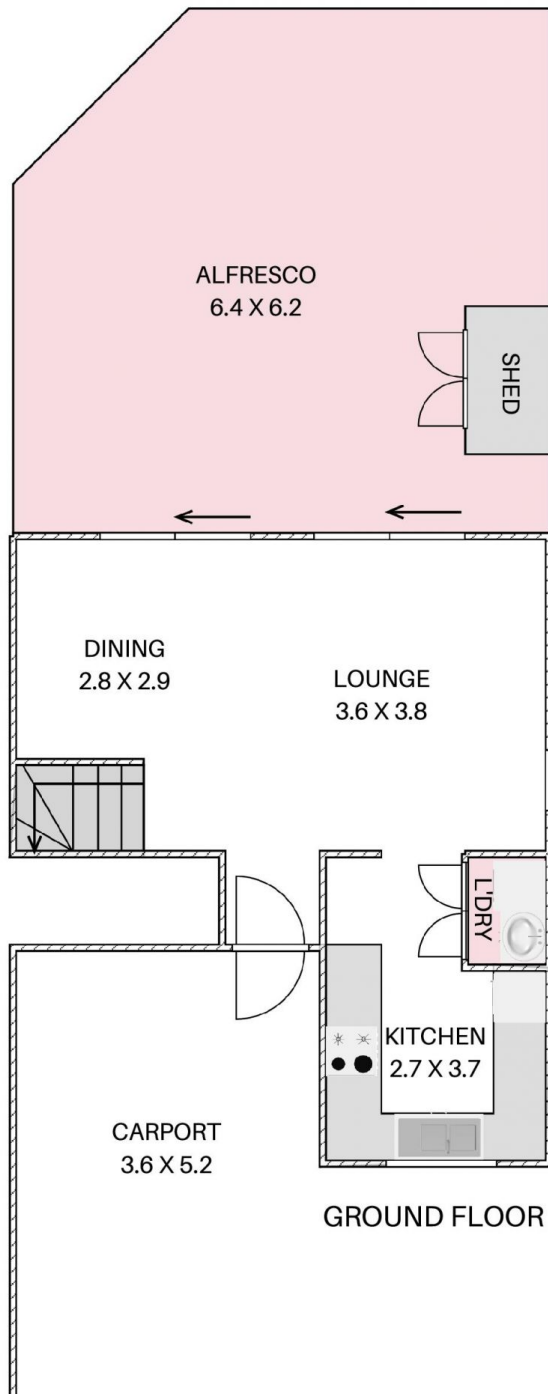

HOUSE TOTAL AREA 147m²

Plans shown are for presentation purposes and are not part of any legal document. Dimensions are approximate.

