



25 Billabong Avenue Dapto NSW

3  1  1 

family | convenience | fresh start

Peacefully tucked away in a great street with easy side access to the rear, on a generous sized block, this neat three-bedroom home enjoys convenience to all amenities such as shops, public transport, cafes, Dapto medical centre, M1 motorway and more.

what you will love...

- > generous sized living with a split system air conditioner and gas heating point
- > updated laminate kitchen with stainless steel appliances and dishwasher, overlooking the backyard

[For full version visit the website](https://www.mcneice.com.au/8488326)

Type : House
Land Size : 556 sqm
View : <https://www.mcneice.com.au/8488326>



Erin McPhillips
02 4284 8536

25 Billabong Avenue,
Dapto

molenaar × mcneice

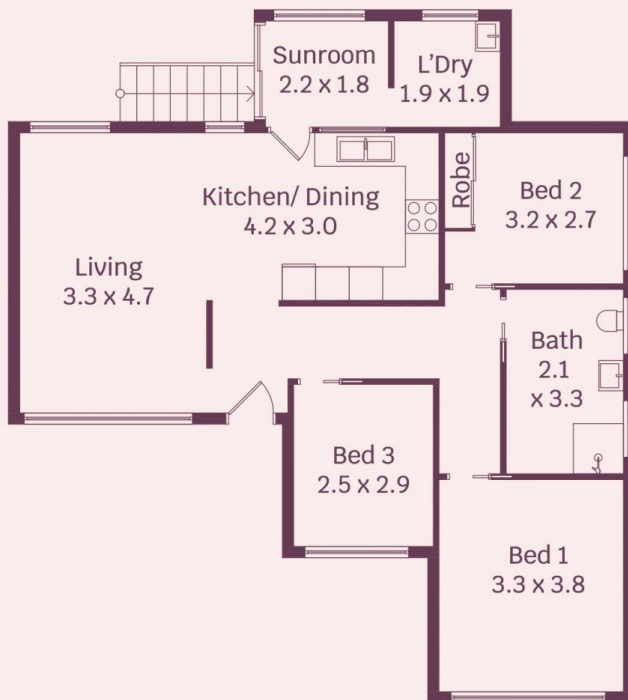
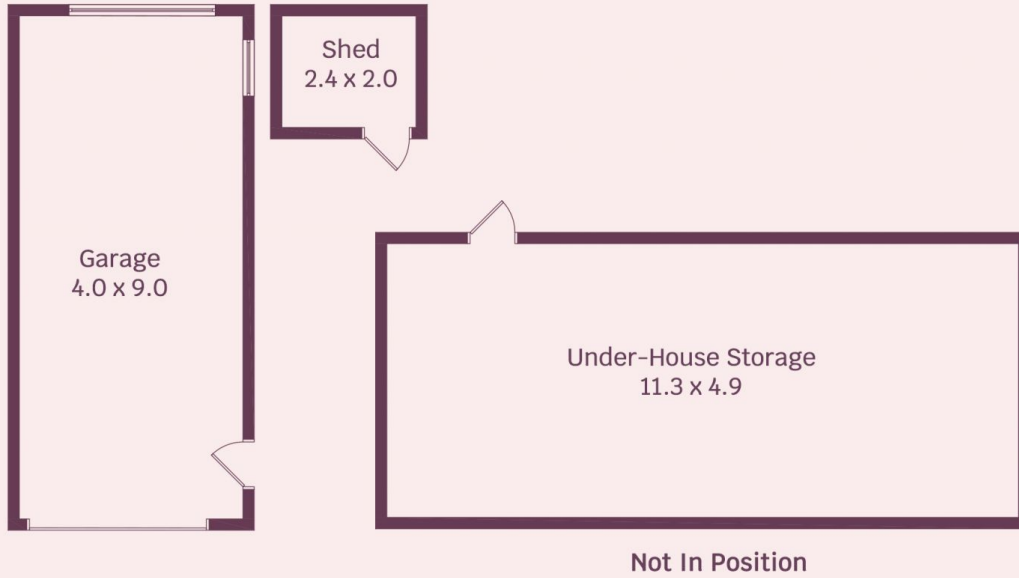

HOUSE INTERNAL AREA 95m²
HOUSE OVERALL AREA 207m²

Plans shown are for presentation purposes and
are not part of any legal document.
Dimensions are approximate