



605/51 Crown Street Wollongong NSW

2 🛏 2 🚿 1 🚗

position | contemporary | outlook

This contemporary north-facing apartment is light-filled with a generous open plan. Located on lower Crown Street, you are just footsteps to cafes, restaurants and shopping. Stylish and versatile interiors boasting contemporary living.

what you will love?

- > fresh interiors and high ceilings flooded with natural sunlight
- > stylish kitchen with smeg stainless steel appliances and breakfast bar
- > private north-facing al-fresco with uninterrupted ocean

[For full version visit the website](https://www.mcneice.com.au/8488275)

Type : Apartment

View : <https://www.mcneice.com.au/8488275>



Mia Atkinson
02 4284 8536



Erin McPhillips
02 4284 8536

605/51 CROWN ST, WOLLONGONG

+ molenaar
mcneice

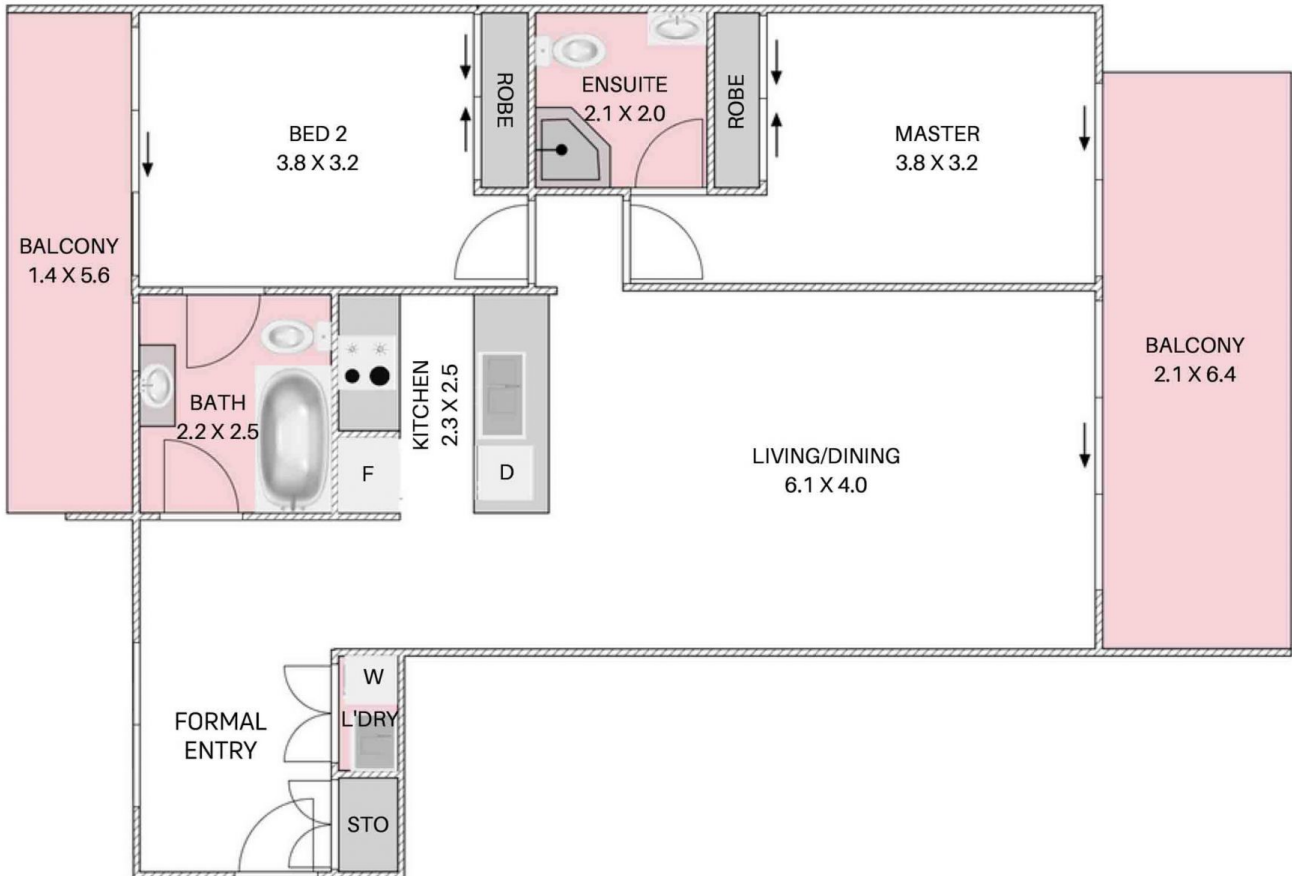

HOUSE TOTAL AREA 108m²

Plans shown are for presentation purposes and are not part of any legal document. Dimensions are approximate.

