



3/45 Campbell Street Woonona NSW

3 2 2

beach | size | position

Positioned on the beachside of Memorial Drive, this oversized semi-detached townhouse offers the chance to live in a prime location that rarely comes to market. Only metres from popular beaches, the home features an impressive living space and bedrooms ideal to suit everyone and make you feel at home.

what you will love...

- > modern kitchen with stone benchtops, quality appliances and gas cooking
- > open plan living and dining area enhanced by hybrid

[For full version visit the website](https://www.mcneice.com.au)

Type : Townhouse

View : <https://www.mcneice.com.au/8488221>



Hilary Moy
02 4284 8536



Erin McPhillips
02 4284 8536

3/45 CAMPBELL STREET, WOONONA

+ molenaar
mcneice

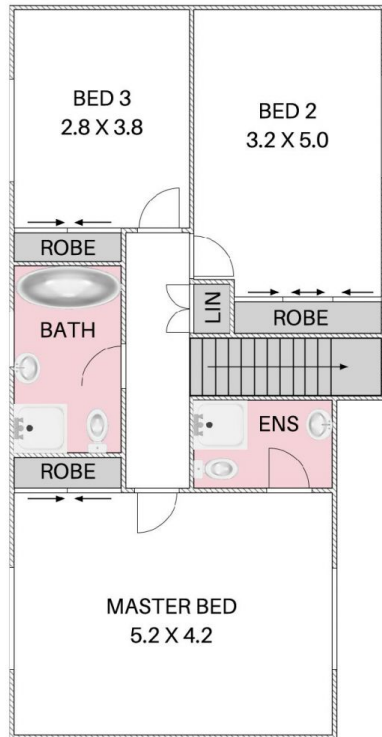

FIRST FLOOR

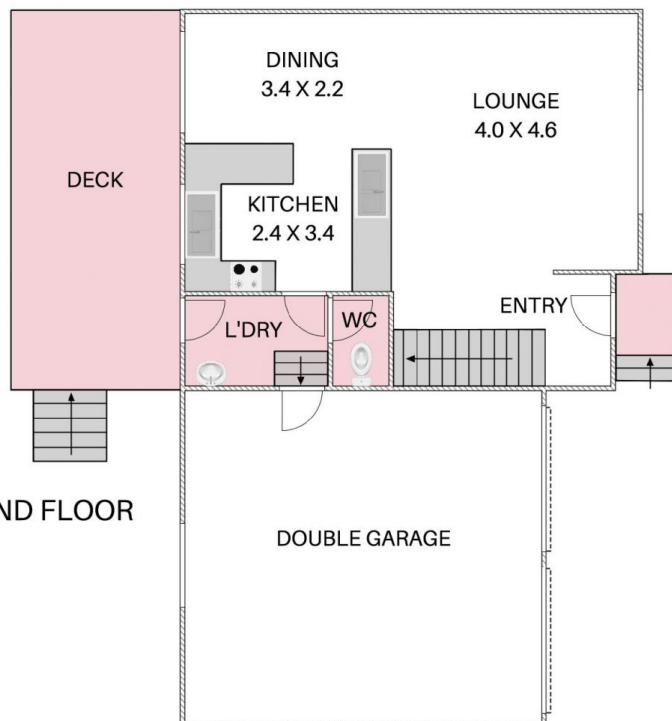

GROUND FLOOR

HOUSE TOTAL AREA 195m²

Plans shown are for presentation purposes and are not part of any legal document. Dimensions are approximate.

