



28 Loch Carron Avenue Farmborough Heights NSW

3 1 1

style | comfort | lifestyle

Beautifully upgraded for family living and move-in ready complete with a big backyard, this solidly built single-storey home is as convenient as it is comfortable moments from neighbourhood parks, CBD transport and Cedars Christian College.

what you will love...

- > rear-elevated and immersed in a peaceful, leafy setting
- > crisp colour schemes, timber floorboards, reverse-cycle A/C
- > open-plan design with spacious lounge plus rear dining

[For full version visit the website](https://www.mcneice.com.au)

Type : House
Land Size : 575 sqm
View : <https://www.mcneice.com.au/8488204>



Hilary Moy
02 4284 8536

28 Loch Caron Avenue,
Farmborough Heights

molenaar × mcneice

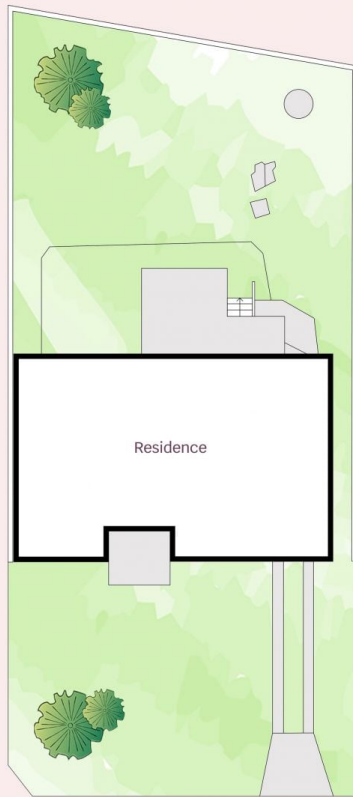

Site plan
(not to scale)



HOUSE INTERNAL AREA 104m²
HOUSE OVERALL AREA 495m²

Plans shown are for presentation purposes and
are not part of any legal document.

Dimensions are approximate