



14/1 Powell Street Mangerton NSW

1 1

location | privacy | aspect

this north-east facing unit is conveniently located in leafy mangerton and tucked away at the end of a private driveway... capture ocean and city glimpses from your balcony while being close to schools, hospitals and wollongong cbd.

what you will love...

- > open plan kitchen, living and dining spaces
- > light-filled and timber flooring throughout
- > north-east aspect with ocean glimpses
- > large sized bedroom with built in wardrobe

[For full version visit the website](https://www.mcneice.com.au)

Type : Apartment

View : <https://www.mcneice.com.au/8488144>



Hilary Moy
02 4284 8536

14/1 POWELL STREET, MANGERTON

+ molenaar
mcneice

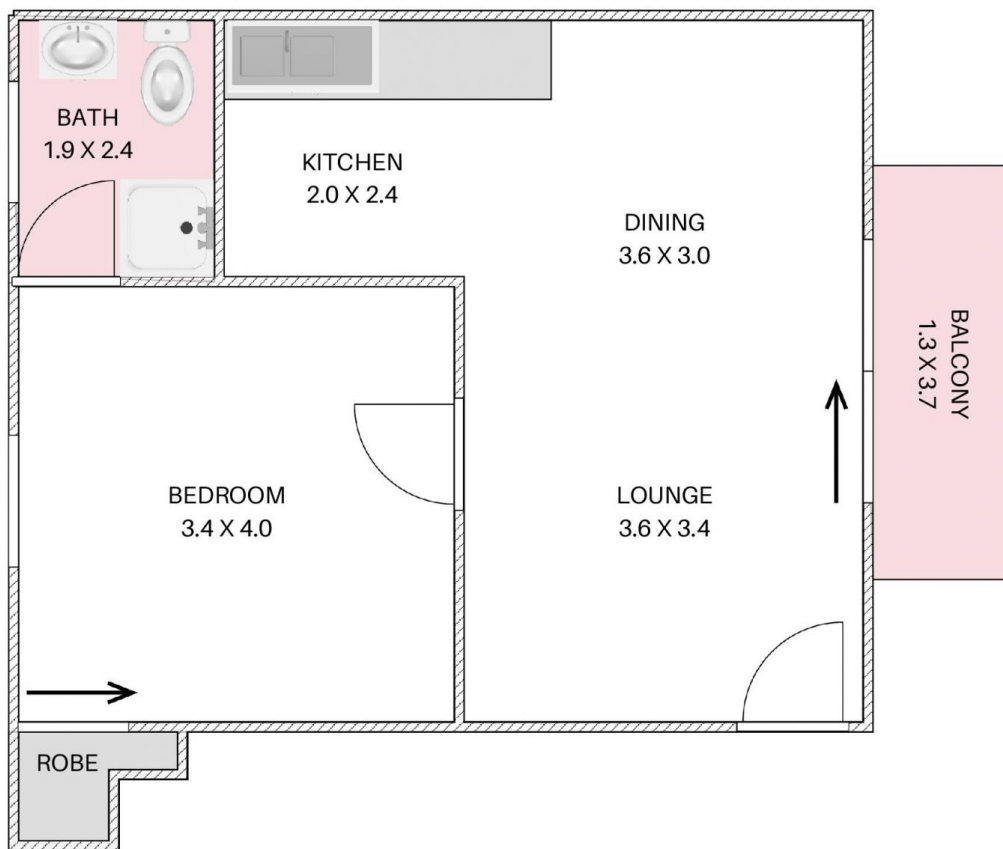

HOUSE TOTAL AREA 50.6m²

Plans shown are for presentation purposes and are not part of any legal document. Dimensions are approximate.