



6/8 Smith Street Wollongong NSW

3 2 2

what you will love?
space | convenience | lifestyle

Located in the Belmore Basin precinct in one of the most popular and tightly held complexes 'North Bay'. Almost house-sized proportions dominate the appeal of the northeast facing sun-drenched apartment.

- + updated throughout with fresh blackbutt flooring and colour schemes
- + north east facing with a large kitchen and open plan living
- + generous updated master bedroom featuring contemporary ensuite

Type : Apartment
View : <https://www.mcneice.com.au/8488039>



Hilary Moy
02 4284 8536



Erin McPhillips
02 4284 8536

[For full version visit the website](https://www.mcneice.com.au)

6/8 SMITH STREET, WOLLONGONG

+ molenaar
mcneice

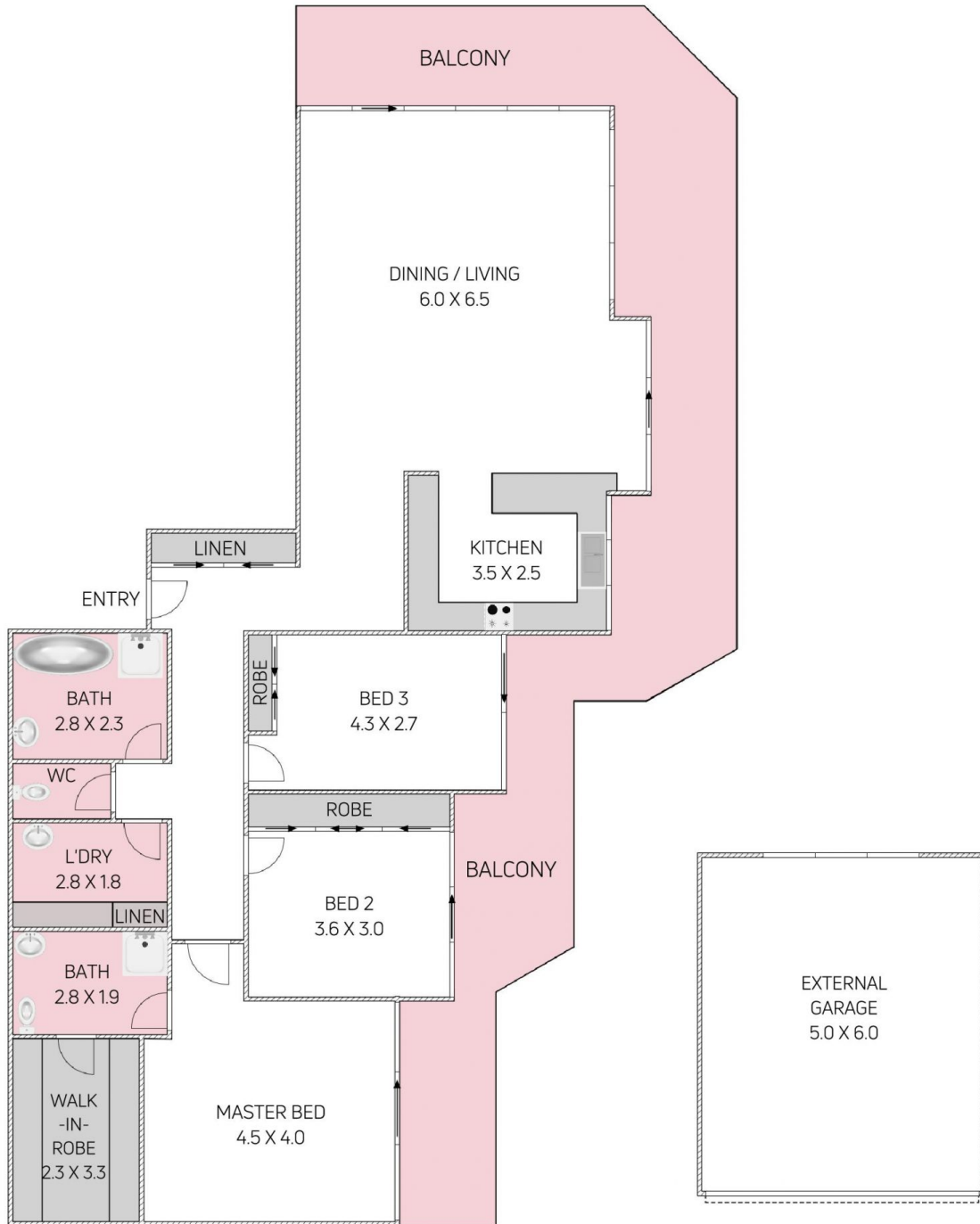

TOTAL LIVING AREA:
231 M²

Plans shown are for presentation purposes and are not part of any legal document. Dimensions are approximate.

