



24 Cross Street Corrimal NSW

4 2 1

peaceful | character | airy

Tucked away at the end of a quiet cul-de-sac, Havenwood is a beautifully reimagined Federation residence that blends classic charm with modern luxury. From its striking façade to its thoughtful interior finishes, every detail has been meticulously considered to create a home that feels effortlessly refined. The sun-soaked wraparound veranda offers a peaceful, leafy outlook. Just moments from Corrimal's vibrant village, schools, and cafes, this home promises a lifestyle of ease, elegance, and timeless appeal.

what you will love...

[For full version visit the website](#)

Type : House
Land Size : 557 sqm
View : <https://www.mcneice.com.au/8484969>



David Hyslop
02 4284 8536



Adam Blackmore
02 4284 8536

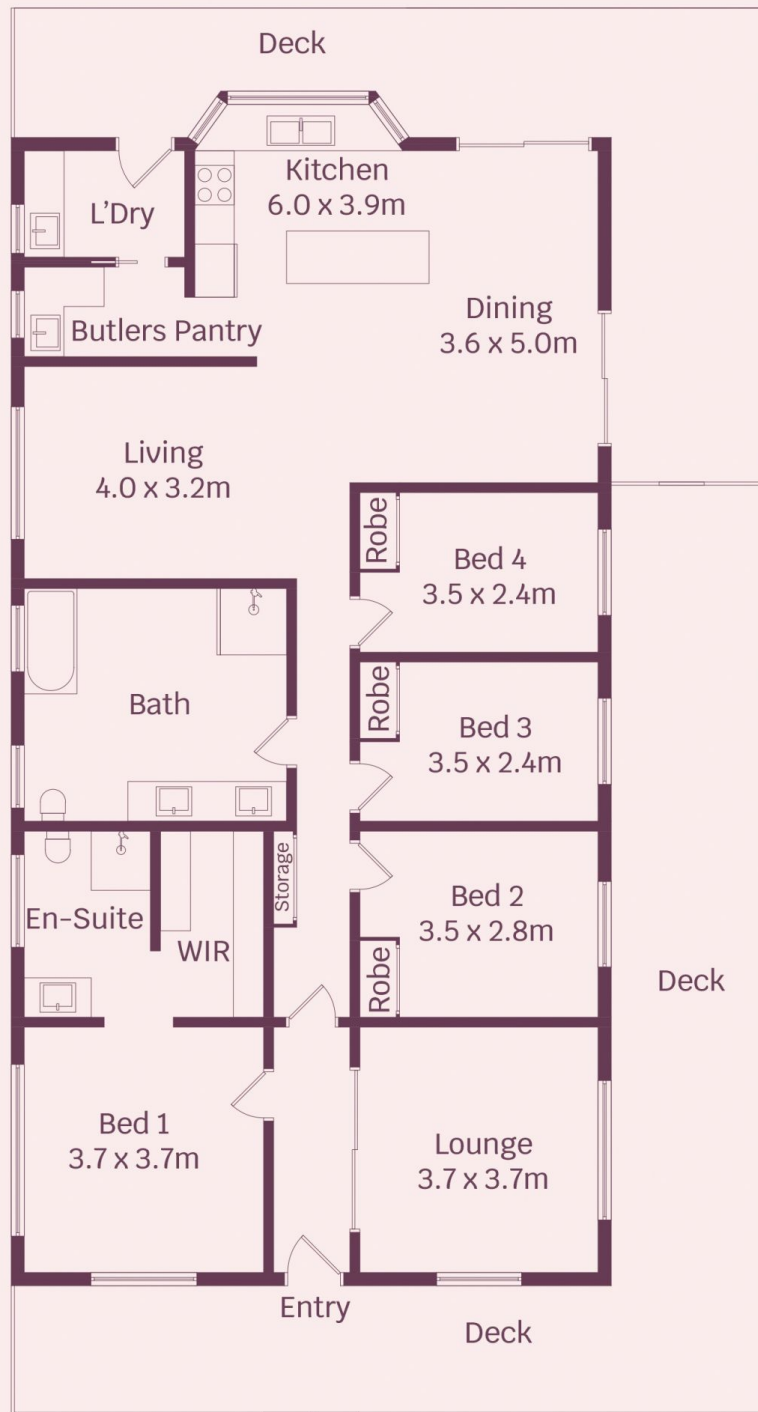

HOUSE INTERNAL AREA 148.3m²

HOUSE OVERALL AREA 246m²

Plans shown are for presentation purposes and are not part of any legal document.

Dimensions are approximate