



## 16 Palmyra Avenue Thirroul NSW

3 2 2

views | style | sunlit

Stunning mid century renovation with a modern twist, filled with natural light throughout, this one-of-a-kind single level home is a rare opportunity in Thirroul. Boasting three bedrooms across a well thought and seamless floorplan, with smooth indoor-outdoor integration and unbeatable views stretching out past Sandon Point, this home is guaranteed to be one to remember.

what you will love...

> open plan, single-level living with seamless indoor/outdoor integration

[For full version visit the website](https://www.mcneice.com.au/8484892)

**Type** : House  
**Price** : \$ 1,920,000  
**Land Size** : 626 sqm  
**View** : <https://www.mcneice.com.au/8484892>



**David Hyslop**  
02 4284 8536

16 Palmyra Avenue, Thirroul

molenaar × mcneice

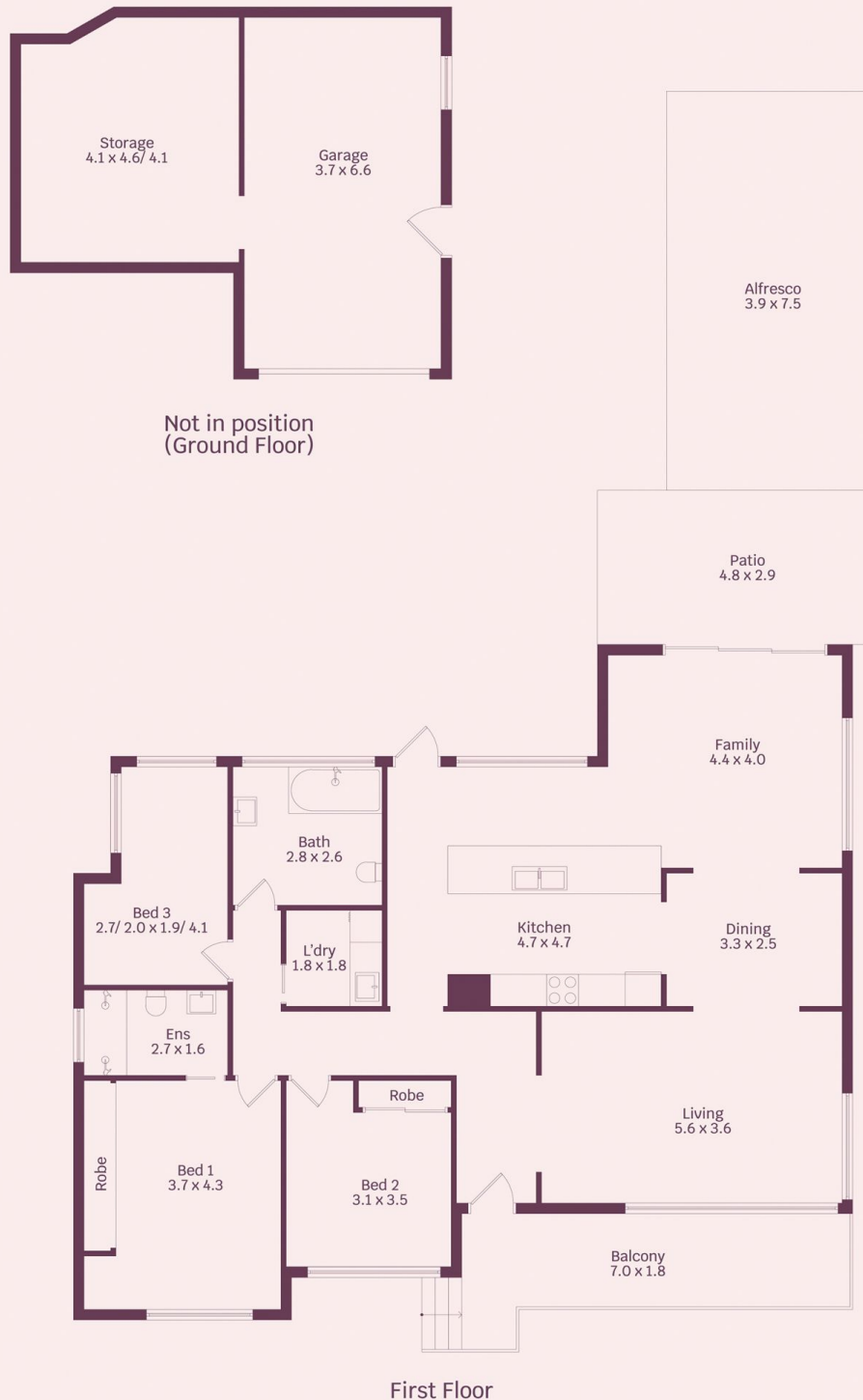

First Floor



HOUSE INTERNAL AREA 195m<sup>2</sup>  
HOUSE OVERALL AREA 254m<sup>2</sup>

Plans shown are for presentation purposes and are not part of any legal document.

Dimensions are approximate