



3/65 Campbell Street Woonona NSW

3 1 2

location | quiet | space

Providing an idyllic beachside lifestyle being just 800m from popular Woonona beach, this split level townhouse presents an unmissable opportunity for first home buyers, downsizers and investors.

what you will love?

- > open plan living and dining with high vaulted ceilings
- > three bedrooms plus large study, ideal for working from home
- > bright and spacious kitchen with plenty of cupboard space

[For full version visit the website](https://www.mcneice.com.au/8484878)

**Type** : Townhouse

**Price** : \$ 930,000

**View** : <https://www.mcneice.com.au/8484878>



**Adam Blackmore**  
02 4284 8536

3/65 Campell Street, Woonona

molenaar × mcneice

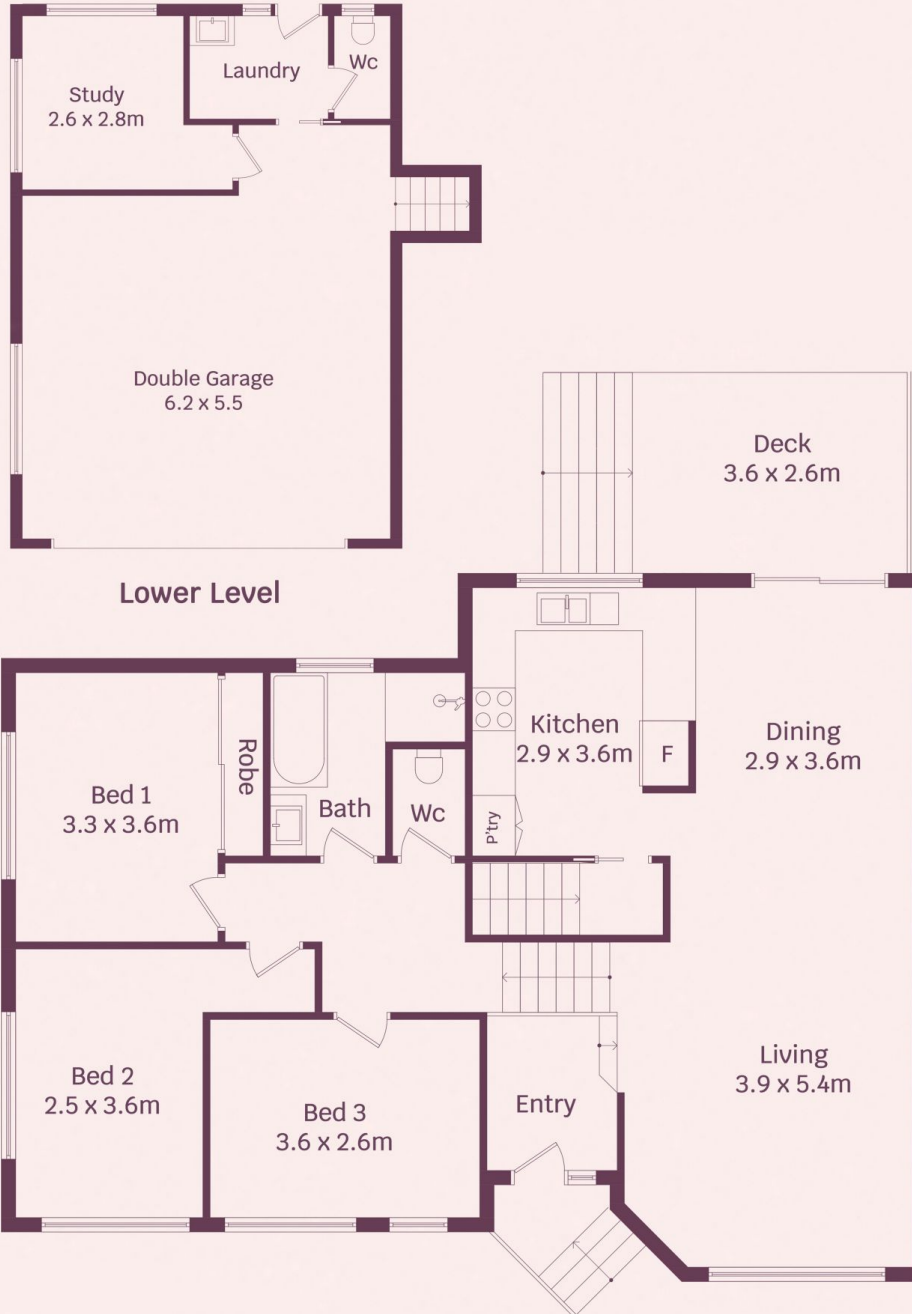

Lower Level

Ground Level



HOUSE INTERNAL AREA 139m<sup>2</sup>  
HOUSE OVERALL AREA 209m<sup>2</sup>

Plans shown are for presentation purposes and are not part of any legal document.  
Dimensions are approximate