



15B Seaview Terrace Thirroul NSW

5 🛏 3 🚿 2 🚗

expansive | entertaining | views

This brand new architecturally crafted home provides the perfect blend of luxury and lifestyle. Nestled in the seaside town of Thirroul, this incredibly spacious and cleverly designed home offers the complete coastal lifestyle with breathtaking ocean and district views. With an impressive 265m² of internal floor space and designed with entertaining in mind, this impressively built home will set a new benchmark in sophisticated coastal living.

what you will love?

> designed with incredible attention to detail, privacy and

[For full version visit the website](#)

Type : Semi Detached
Land Size : 550 sqm
View : <https://www.mcneice.com.au/8484798>



Adam Blackmore
02 4284 8536

15b Seaview Terrace, Thirroul

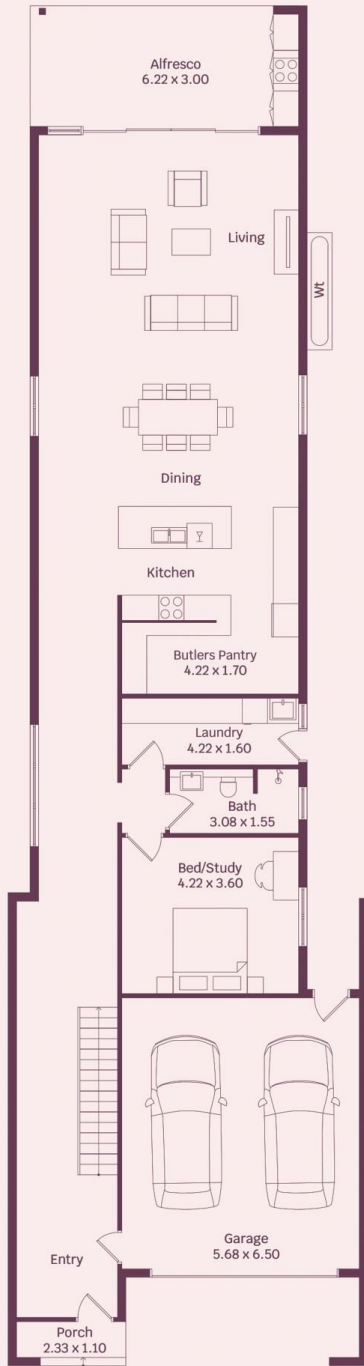

Ground Floor

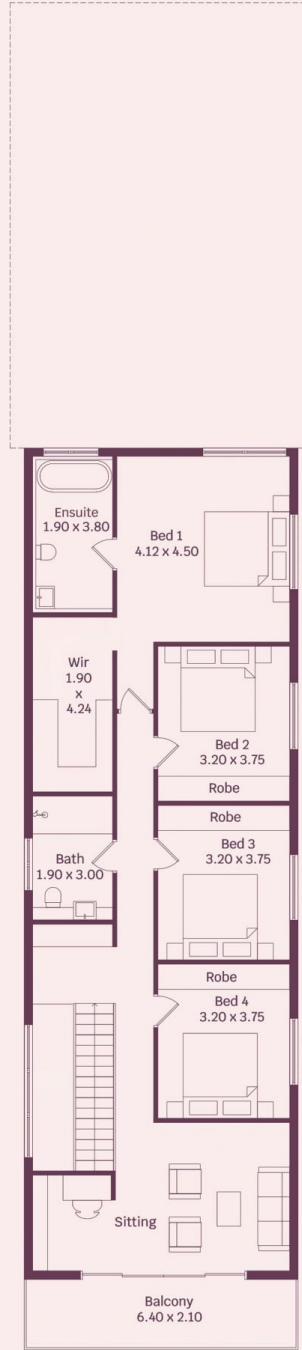

First Floor

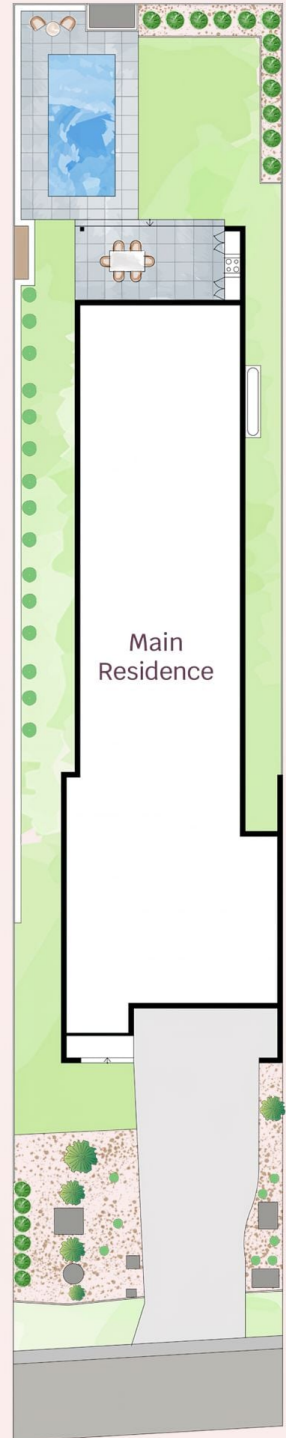

HOUSE INTERNAL AREA 265m²

Plans shown are for presentation purposes and are not part of any legal document.
Dimensions are approximate