



15A Seaview Terrace Thirroul NSW

5 🛏 3 🚿 2 🚗

expansive | entertaining | views

These brand new architecturally crafted homes provide the perfect blend of luxury and lifestyle. Nestled in the seaside town of Thirroul, these incredibly spacious and cleverly designed homes offer the complete coastal lifestyle with breathtaking ocean and district views. With an impressive 265m² of internal floor space and designed with entertaining in mind, these impressively built homes will set a new benchmark in sophisticated coastal living.

what you will love?

> designed with incredible attention to detail, privacy and

[For full version visit the website](https://www.mcneice.com.au)

Type : House
Building Size : 265 sqm
Land Size : 550 sqm
View : <https://www.mcneice.com.au/8484772>



Adam Blackmore
02 4284 8536

15a Seaview Terrace, Thirroul

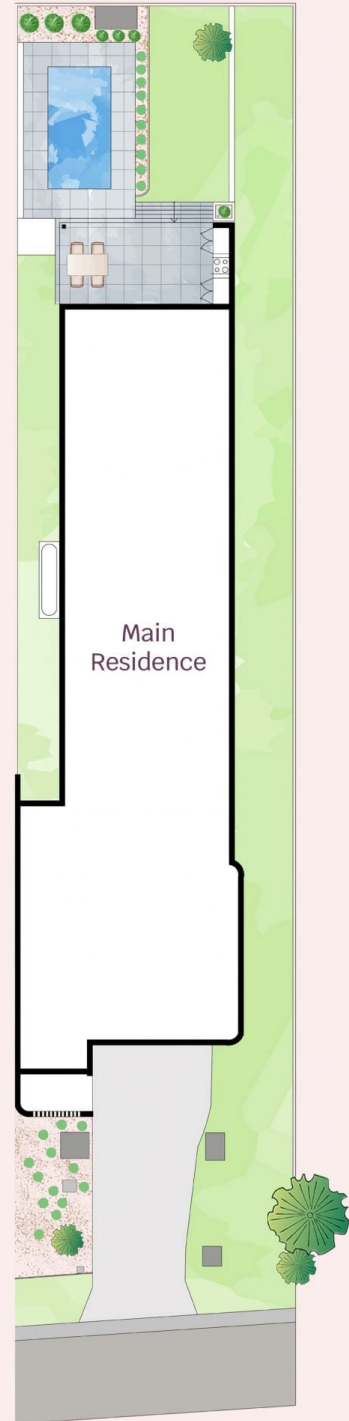
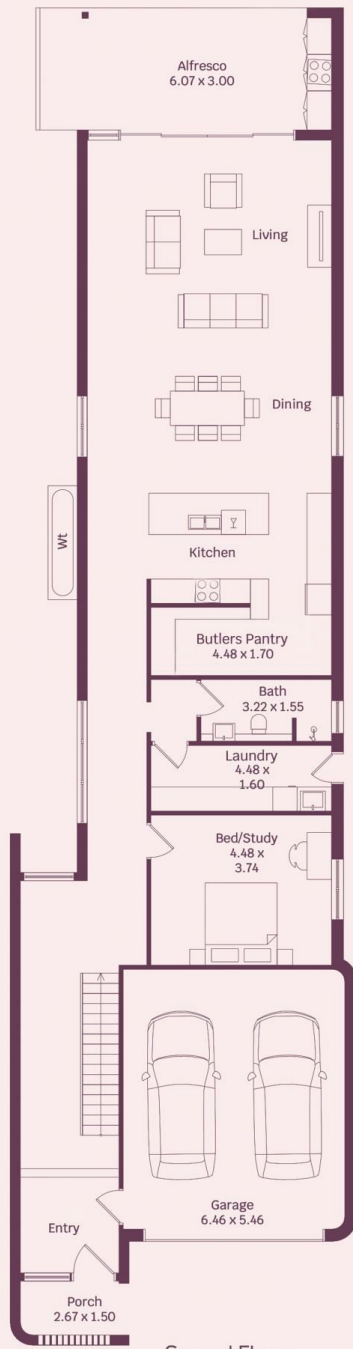

HOUSE INTERNAL AREA 262m²
 Plans shown are for presentation purposes and
 are not part of any legal document.
 Dimensions are approximate