



10 Gardiner Place Helensburgh NSW

4 2 2

what you will love?

spacious | entertaining | privacy

Privately positioned in a tightly held cul-de-sac, this generously proportioned family home offers a quiet and stress-free lifestyle whilst being only moments from the Royal National Park and the express train line to Sydney.

- + whisper quiet location with gorgeous bushland views
- + spacious main living room with original wood fireplace and high ceilings
- + modern kitchen with stainless steel appliances and Caesarstone benchtops
- + multiple living spaces plus formal and casual dining

[For full version visit the website](https://www.mcneice.com.au)

Type : House
Price : \$ 1,160,000
Land Size : 640 sqm
View : <https://www.mcneice.com.au/8484685>



Adam Blackmore
02 4284 8536



Daniel Mulholland
02 4284 8536

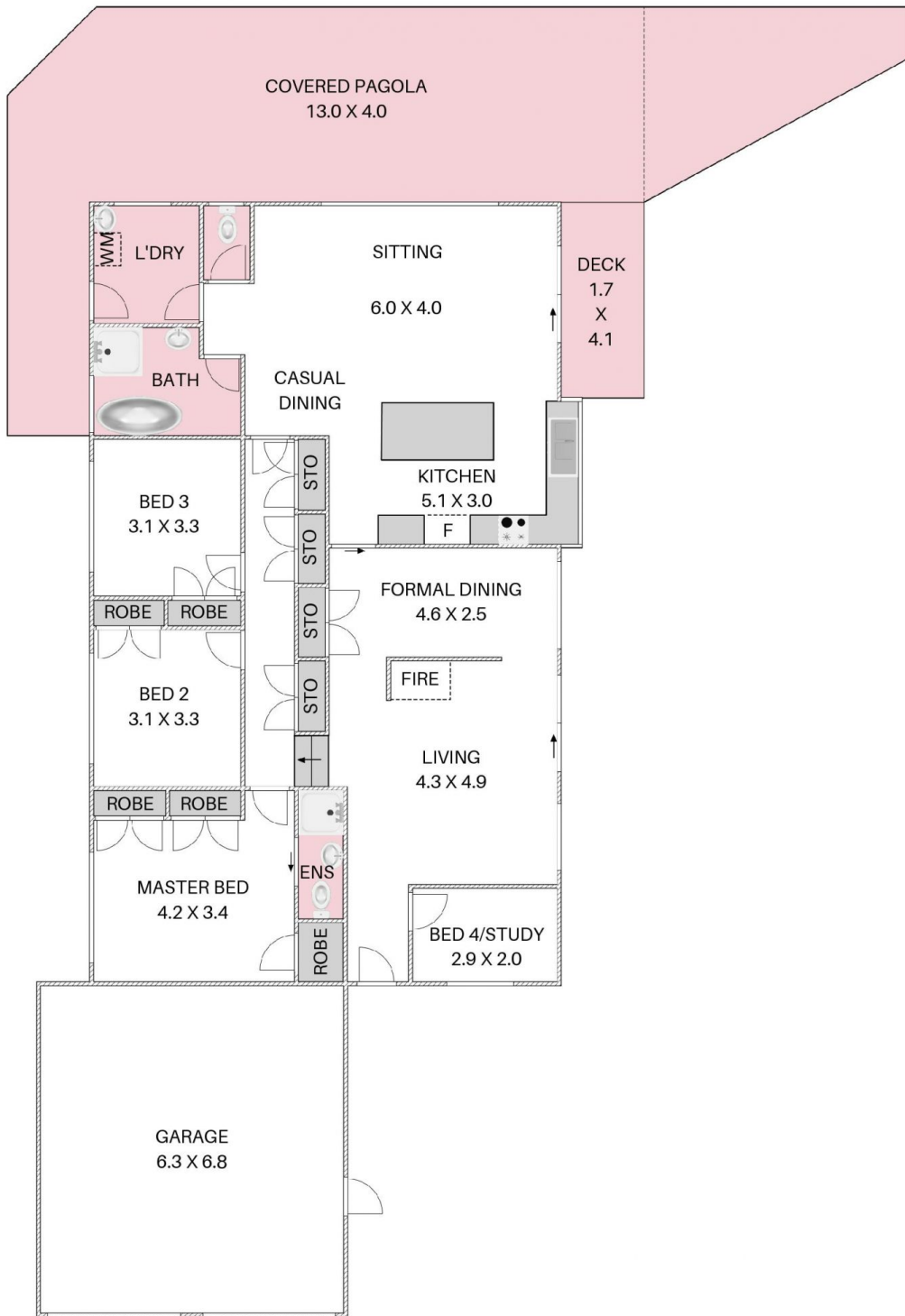

HOUSE INTERNAL AREA: 196m²
TOTAL AREA: 276m²

Plans shown are for presentation purposes and are not part of any legal document. Dimensions are approximate.

