



3 Ashton Vale Grove Horsley NSW

5 2 2

what you will love?
family | size | opportunity

Set on a sun-drenched 754sqm block, with side access and an inground pool, this expansive home is the perfect opportunity for a growing family looking for their forever home. Located in a quiet street only a short distance to Dapto CBD.

- + large house featuring five bedrooms with built-in wardrobes
- + study and multiple living areas, perfect for larger families
- + modern open plan kitchen, gas cooking, ample bench and storage space

[For full version visit the website](https://www.mcneice.com.au)

Type : House
Price : \$ 960,000
Land Size : 754 sqm
View : <https://www.mcneice.com.au/8484599>



Matthew Stipcevic
02 4284 8536



Danny Peterson
02 4284 8536

3 ASHTON VALE GROVE, HORSLEY

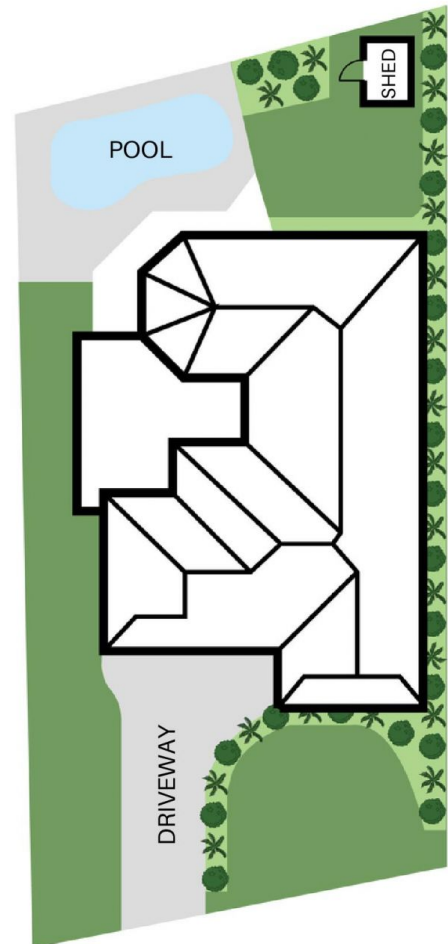
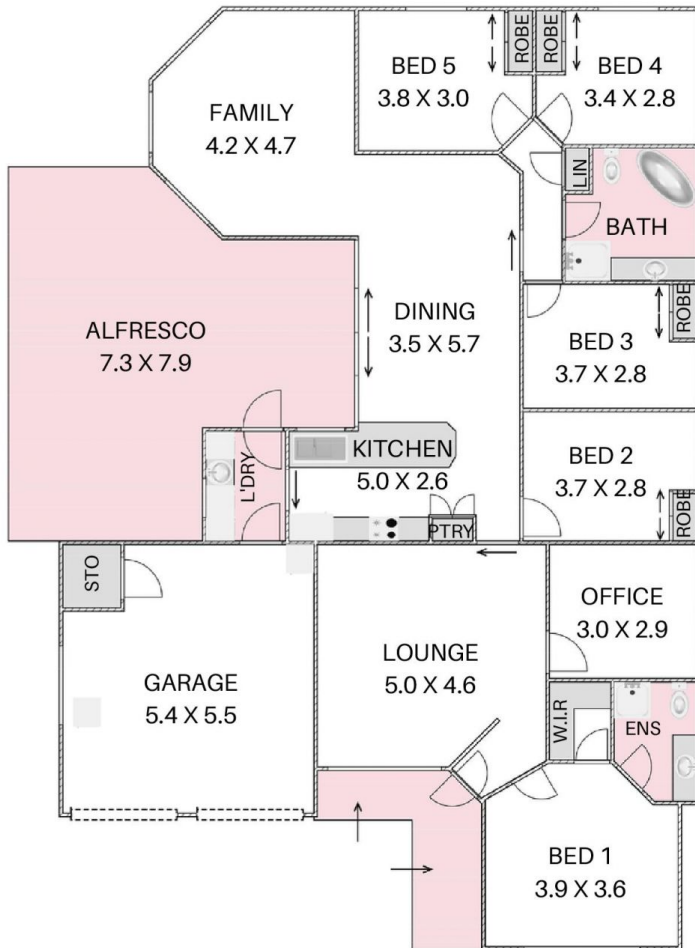

SITEPLAN

HOUSE TOTAL AREA 260m²

Plans shown are for presentation purposes and are not part of any legal document. Dimensions are approximate.

