



## 16b Waterloo Street Bulli NSW

3 1 2

what you will love...  
tranquil | location | lifestyle

A light-filled and cosy home with rustic beach cottage vibes & a tranquil tropical feel. Located in highly sought after East Bulli, a short stroll to the beach, parks, cafes, schools, train station and local shopping village. This modern and appealing property offers open-plan dining and living that flows out to a spacious covered deck for entertaining. Surrounded by lush tropical greenery, mature fruit trees and palms makes for a beautiful and private space to enjoy and relax in.

+ renovated kitchen with timber tops and stainless steel

[For full version visit the website](#)

**Type** : House  
**Land Size** : 552 sqm  
**View** : <https://www.mcneice.com.au/8484524>



**Daniel Mulholland**  
02 4284 8536



**Adam Blackmore**  
02 4284 8536

16B WATERLOO STREET, BULLI

+ molenaar  
mcneice

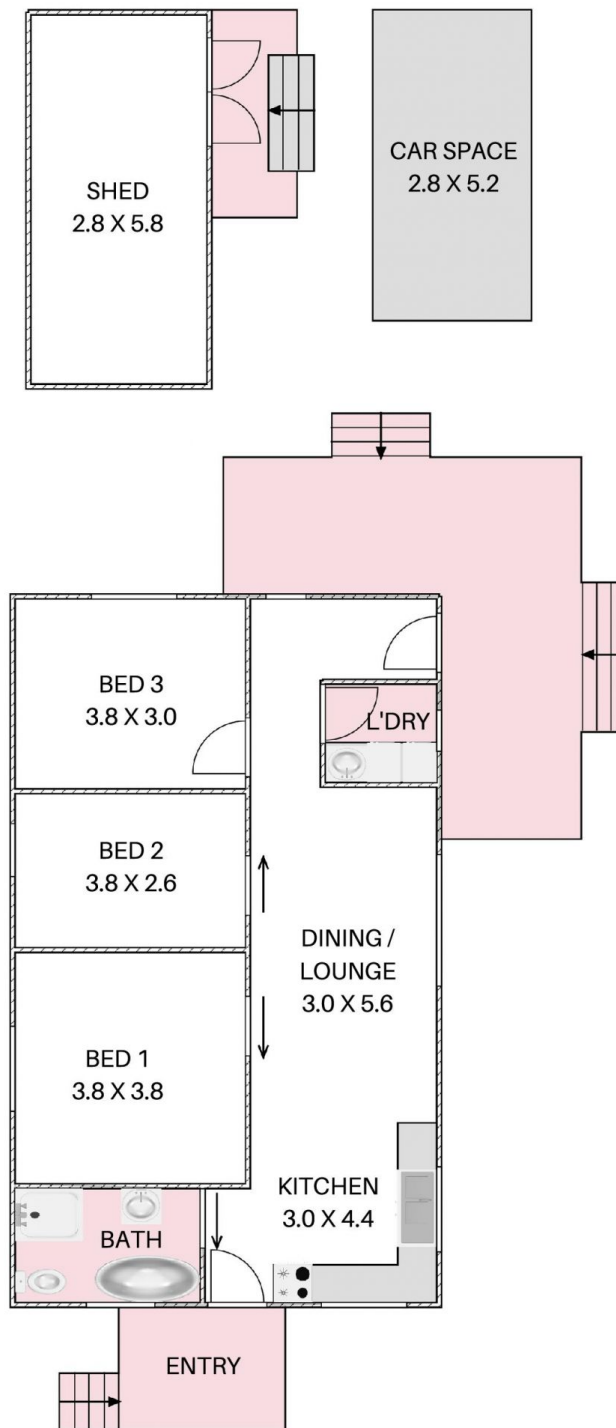

HOUSE TOTAL AREA 134m<sup>2</sup>

Plans shown are for presentation purposes and are not part of any legal document. Dimensions are approximate.

