



444 Lawrence Hargrave Drive Scarborough NSW

4 🛏 2 🚿 2 🚗

what you will love...

privacy | architecture | entertaining

Set in a highly desired coastal enclave with rear access via Goodrich Street, this architecturally built modern home is finished with the highest-level fixtures and fittings. Featuring on Australia's best houses this heritage listed miner's cottage is one of the regions finest coastal cottages.

- + seamless indoor/outdoor entertaining
- + unique design boasting a versatile floorplan for varying lifestyles
- + induction cooktop and double oven

[For full version visit the website](https://www.mcneice.com.au)

**Type** : House  
**Land Size** : 456 sqm  
**View** : <https://www.mcneice.com.au/8484498>



**David Hyslop**  
02 4284 8536

444 LAWRENCE HARGRAVE DRIVE,  
SCARBOROUGH

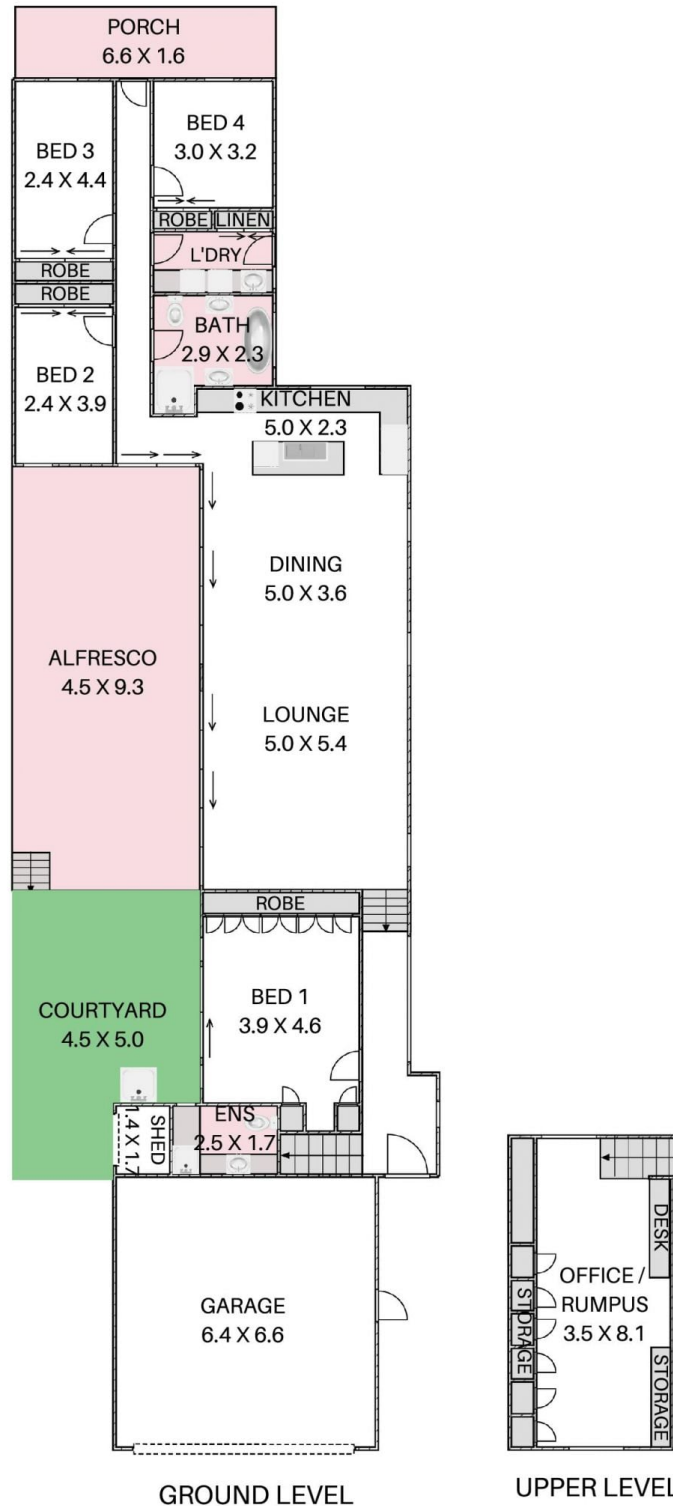

HOUSE TOTAL AREA 225m<sup>2</sup>

Plans shown are for presentation purposes and are not part of any legal document. Dimensions are approximate.

