



6/39 Collaery Road Russell Vale NSW

2 1 1

what you will love?

peaceful | low-maintenance | natural light

In a meticulously cared for complex, near public transport, parks, schools, Corrimal's shops and surfing spots this modern two-bedroom townhouse is the perfect opportunity to enter the market. With an easy-to-follow floorplan where the living area opens onto a low maintenance yard. Semi-detached from the neighbours and light filled interiors it is truly tranquil lifestyle retreat over two generous levels.

+ neat and tidy kitchen with ample bench and cupboard space

+ open plan living and dining area with reverse cycle

Type : Townhouse

Price : \$ 670,000

View : <https://www.mcneice.com.au/8484489>



Daniel Mulholland
02 4284 8536



Adam Blackmore
02 4284 8536

[For full version visit the website](https://www.mcneice.com.au)

6/39 COLLAERY ROAD, RUSSELL VALE

+ molenaar
mcneice

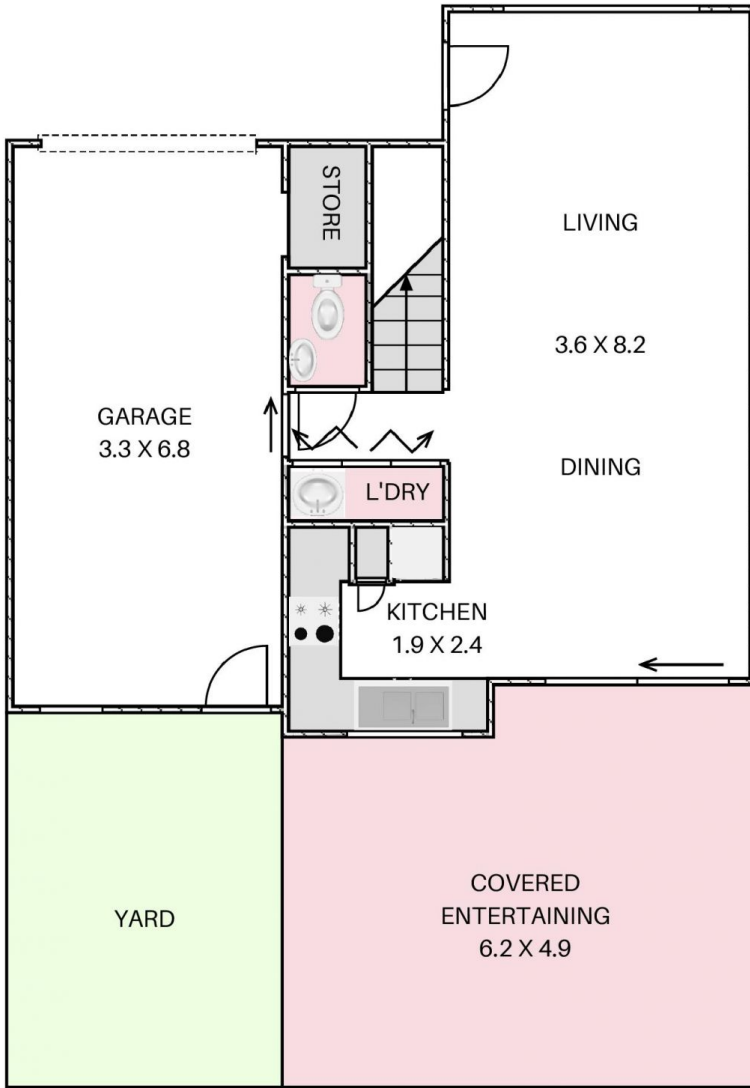

GROUND FLOOR

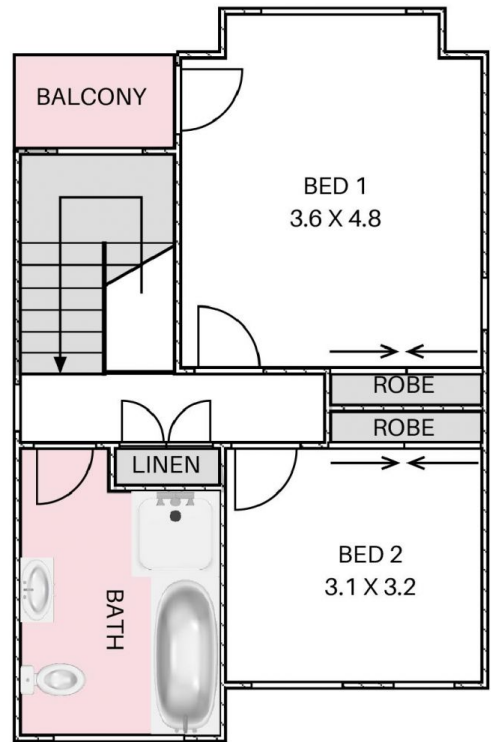

FIRST FLOOR

HOUSE TOTAL AREA 153m²

Plans shown are for presentation purposes and are not part of any legal document. Dimensions are approximate.

