

## 62 Terania Street Russell Vale NSW

4 2 8

what you will love...  
views | location | size

Basking in north to rear sunshine with a beautiful escarpment backdrop, this spacious family home is positioned in an iconic street, close to parks, schools, cafes, and golf courses. Set on a generous 708sqm allotment, this home boasts a generous floor plan, immaculately renovated interiors, and a huge shed ideally suited to tradies or enthusiasts.

- + fresh, neutral palette with modern fixtures and fittings
- + large island kitchen with gas cooktop and double oven
- + modern bathroom plus additional bathroom off laundry

[For full version visit the website](https://www.mcneice.com.au)

**Type** : House  
**Price** : \$ 1,351,000  
**Land Size** : 708 sqm  
**View** : <https://www.mcneice.com.au/8484436>



**Troy McNeice**  
02 4284 8536



**David Hyslop**  
02 4284 8536

62 TERANIA STREET, RUSSELL VALE

+ molenaar  
mcneice

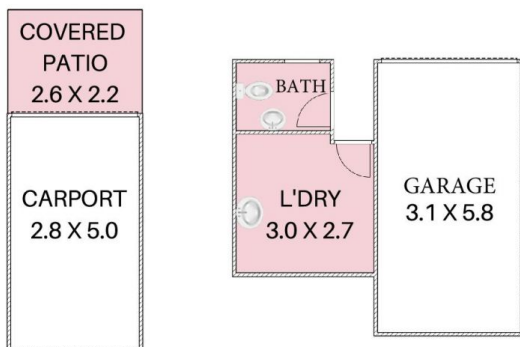
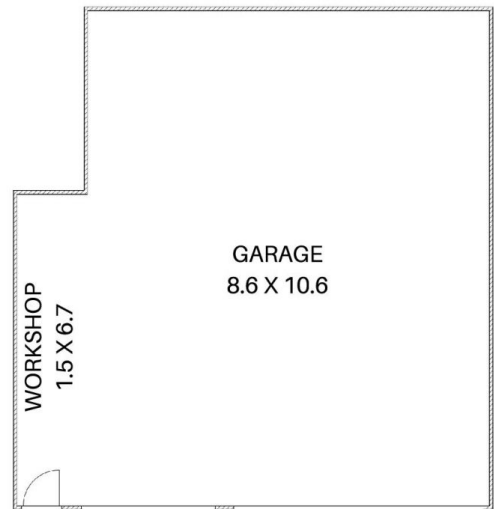
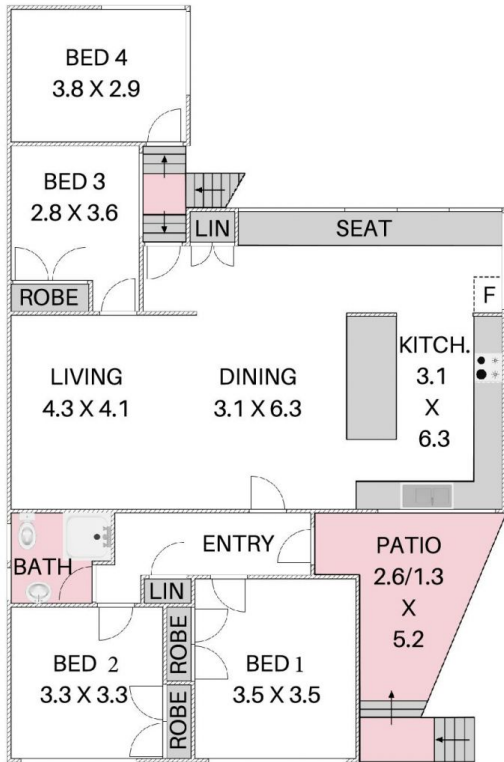

HOUSE TOTAL AREA 286m<sup>2</sup>

Plans shown are for presentation purposes and are not part of any legal document. Dimensions are approximate.

