



42 Hillcrest Avenue Woonona NSW

4 2 1

what you will love?
style | size | location

Enduring charm meets functional family living with this 1940s bungalow. Sitting pretty on an 860 sqm block with a fresh blend of character and comfort. Simply enjoy the home and the prime location just moments from Woonona's conveniences.

- + timber flooring, high ornate ceilings, picture rails, air conditioning
- + multiple living areas with family living and separate rumpus room
- + lambert kitchen with ample bench space and gas cooking

[For full version visit the website](https://www.mcneice.com.au)

Type : House
Price : \$ 1,886,000
Land Size : 860 sqm
View : <https://www.mcneice.com.au/8484417>



David Hyslop
02 4284 8536

42 HILLCREST AVE, WOONONA

+ molenaar
mcneice

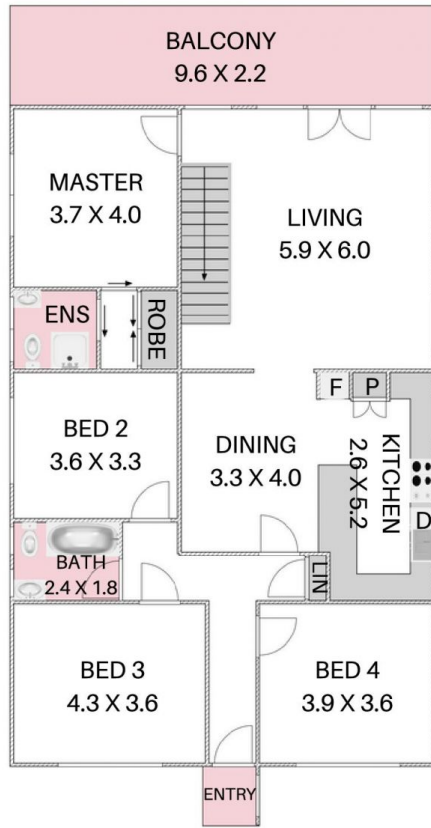

UPPER LEVEL

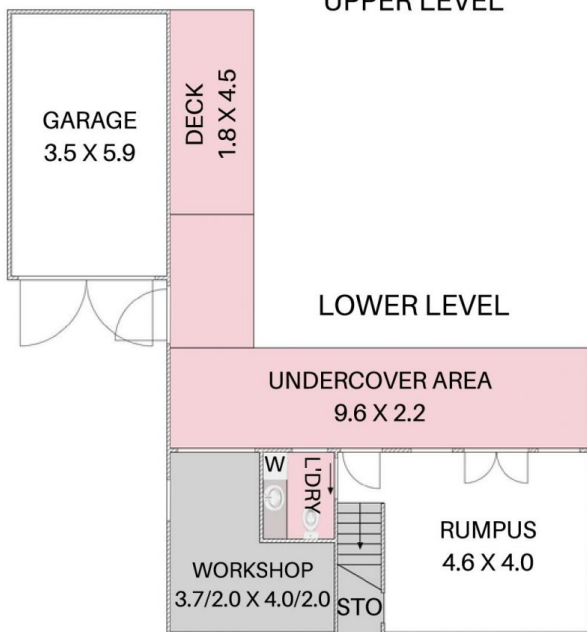

LOWER LEVEL



SITE PLAN



Plans shown are for presentation purposes and are not part of any legal document. Dimensions are approximate.

HOUSE TOTAL AREA 234.1m²
SITE TOTAL AREA 865.6m²