



## 605/51 Crown Street Wollongong NSW

2 🛏 2 🚿 1 🚗

what you will love?  
position | contemporary | outlook

Positioned on the top floor on level 6, this contemporary north-facing apartment is light-filled with a generous open plan. Located on lower Crown Street, you are just footsteps to several cafes, restaurants, shopping, ipac and Town Hall. Stylish and versatile interiors are ready to immediately accommodate an array of buyers from investors to downsizers and first home buyers seeking a highly convenient inner-city lifestyle.

+ fresh interiors and high ceilings flooded with natural sunlight

[For full version visit the website](#)

**Type** : Apartment  
**Price** : \$ 755,000  
**View** : <https://www.mcneice.com.au/8484399>



**Danny Peterson**  
02 4284 8536



**Daniel Mulholland**  
02 4284 8536

605/51 CROWN ST, WOLLONGONG

+ molenaar  
mcneice

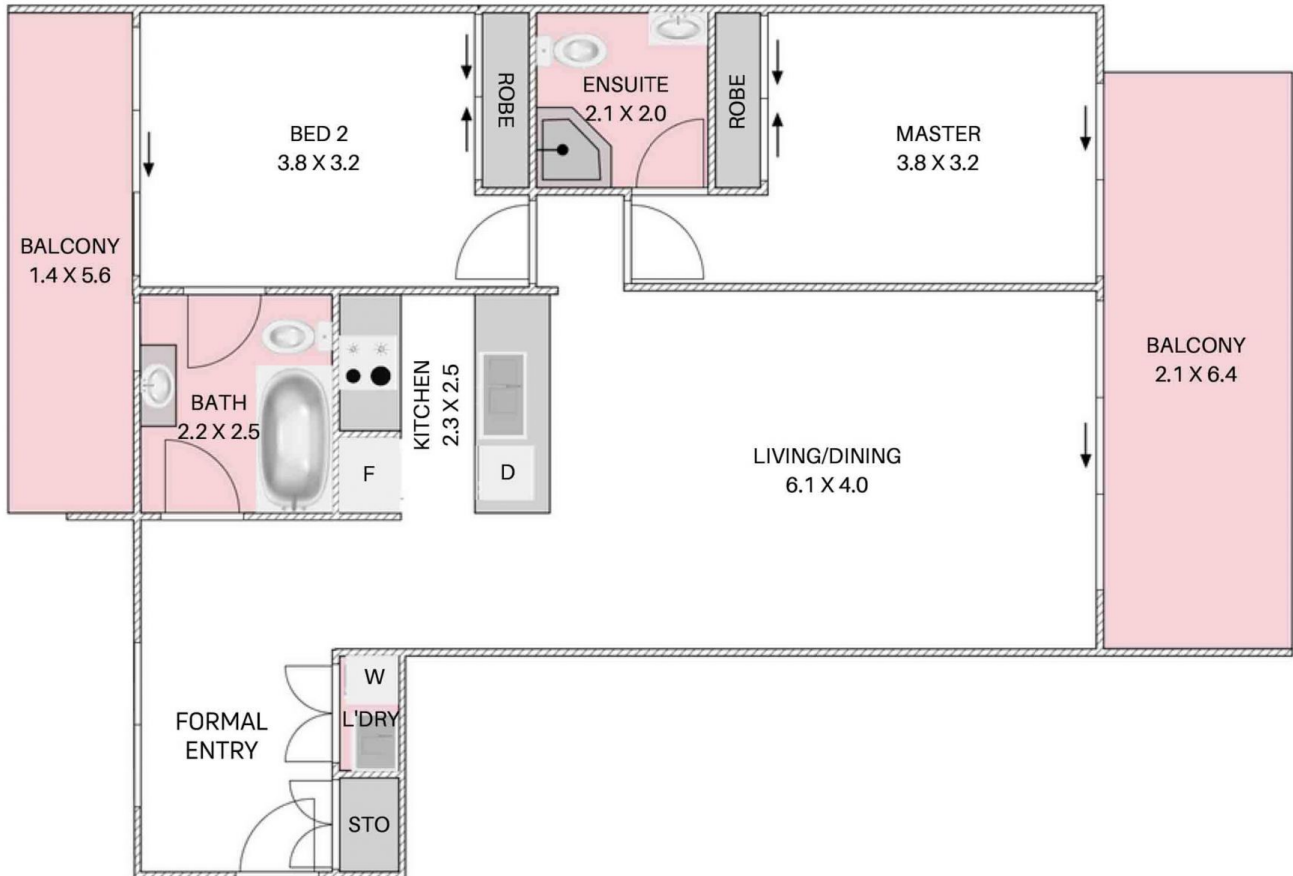

HOUSE TOTAL AREA 108m<sup>2</sup>

Plans shown are for presentation purposes and are not part of any legal document. Dimensions are approximate.

