



## 268 Cordeaux Road Mount Kembla NSW

3 2 2

what you will love?  
acreage | gardens | character

Set in the heart of the historic Mount Kembla village, this private farmhouse is set well off the road behind electric gates. Positioned on a sprawling (almost) 1.5 acres of cleared and usable land ideal for those looking for your own getaway.

- + the homestead has northerly views captured by the wide wrap-around verandas
- + featuring exposed beams, high pitched ceilings and air conditioning throughout
- + country style kitchen with stainless steel appliances and

[For full version visit the website](https://www.mcneice.com.au)

**Type** : House  
**Price** : \$ 2,200,000  
**Land Size** : 5934 sqm  
**View** : <https://www.mcneice.com.au/8484386>



**Danny Peterson**  
02 4284 8536

268 CORDEAUX ROAD, MOUNT KEMBLA

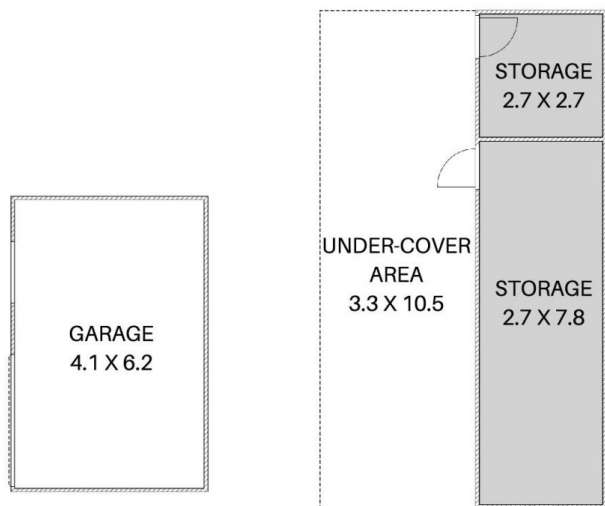
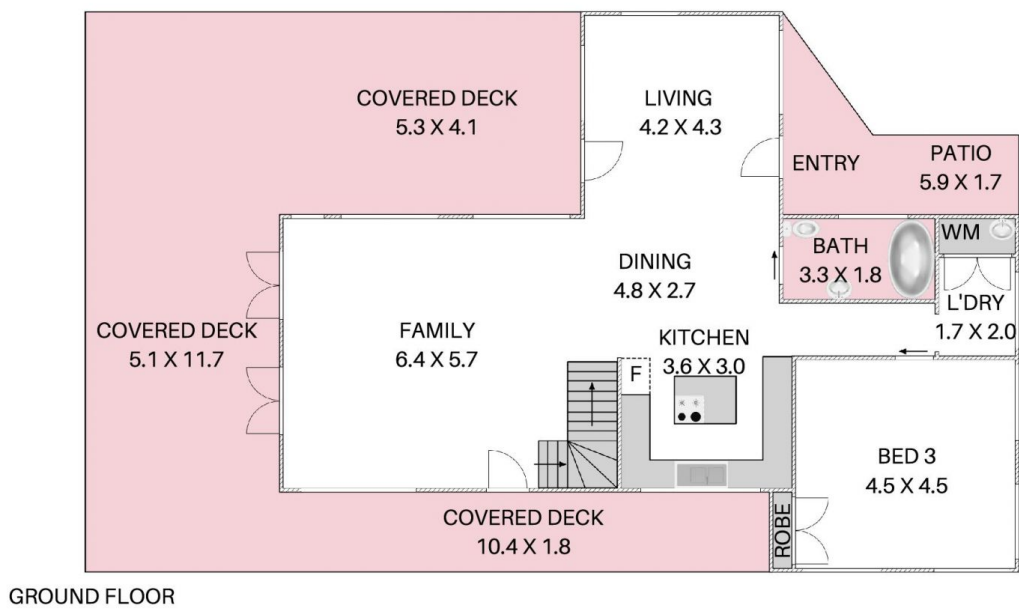
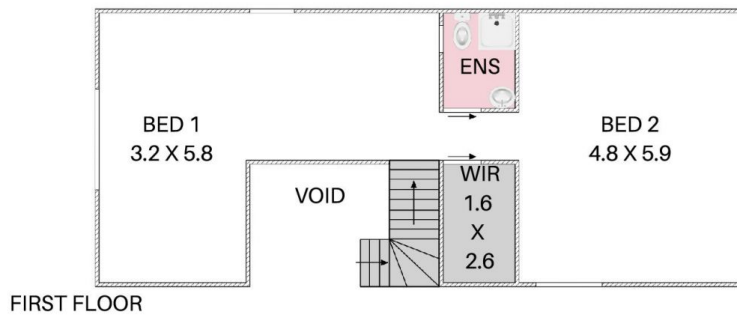

HOUSE TOTAL AREA 292m<sup>2</sup>

Plans shown are for presentation purposes and are not part of any legal document. Dimensions are approximate.

