

## 28 Langson Avenue Figtree NSW

4 2 2

what you will love?  
position | potential | size

Opportunity knocks for this high-side home that rests on one of the area's best streets with a 15m frontage and prime north-facing 1,018sqm block. The solid, single level home has been tightly held, presenting a neat and tidy condition with a wealth of potential. Renovate and explore its possibilities.

- + wide and quiet street, perfectly positioned on the high-side
- + convenient casual dining and tidy vintage kitchen, electric stove

[For full version visit the website](https://www.mcneice.com.au)

**Type** : House  
**Price** : \$ 1,287,000  
**Land Size** : 1018 sqm  
**View** : <https://www.mcneice.com.au/8484377>



**Danny Peterson**  
02 4284 8536

28 LANGSON AVE, FIGTREE

+ molenaar  
mcneice

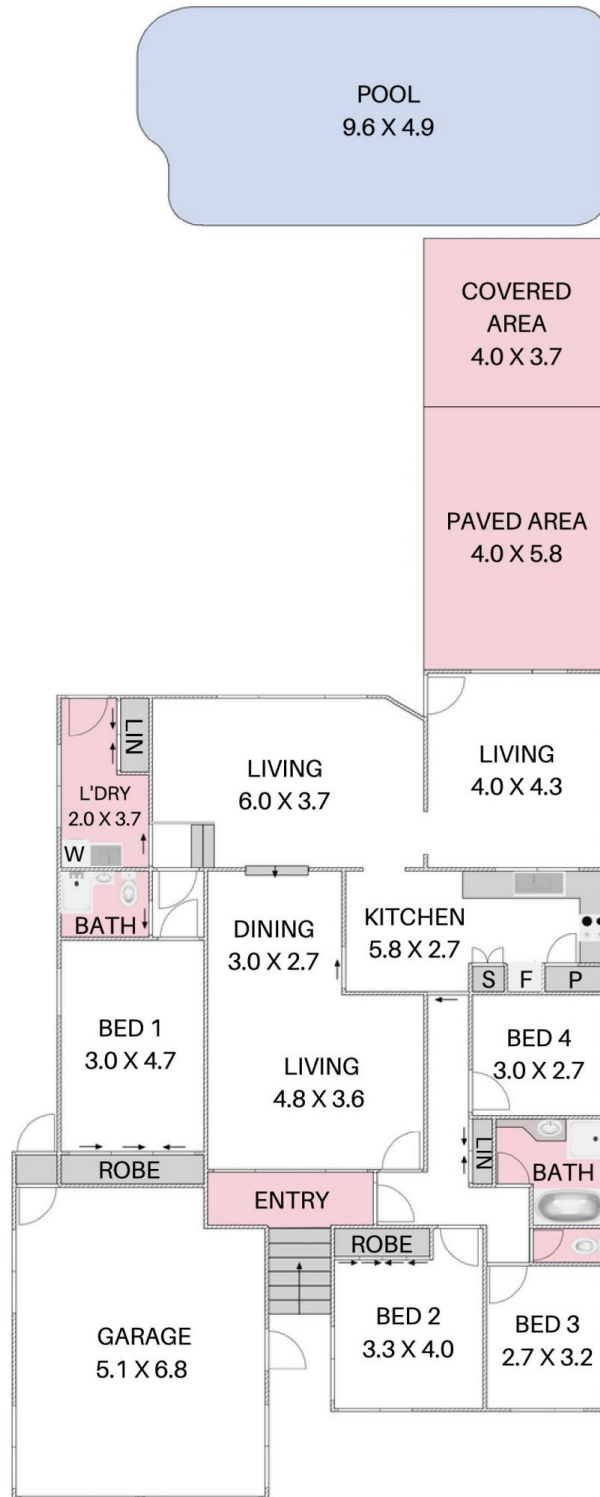

Plans shown are for presentation purposes and are not part of any legal document. Dimensions are approximate.

HOUSE TOTAL AREA 287.7m<sup>2</sup>