



25/50 Keira Street Wollongong NSW

2 1 1

what you will love...
coastal | size | lifestyle

Located in a well-established complex within walking distance of popular beaches, North Wollongong Station and Wollongong Central, this recently renovated apartment offers an exciting lifestyle ideal for those seeking their first home, considering downsizing, or an ideal investment.

- + light-filled and airy apartment with gorgeous escarpment outlook
- + renovated kitchen with stone benchtops, dishwasher and Bosch appliances
- + combined living and dining arrangements, ideal for space

[For full version visit the website](https://www.mcneice.com.au)

Type : Apartment
Price : \$ 540,000
View : <https://www.mcneice.com.au/8484347>



Matthew Stipcevic
02 4284 8536



Danny Peterson
02 4284 8536

25/50-52 KEIRA STREET, WOLLONGONG

+ molenaar
mcneice

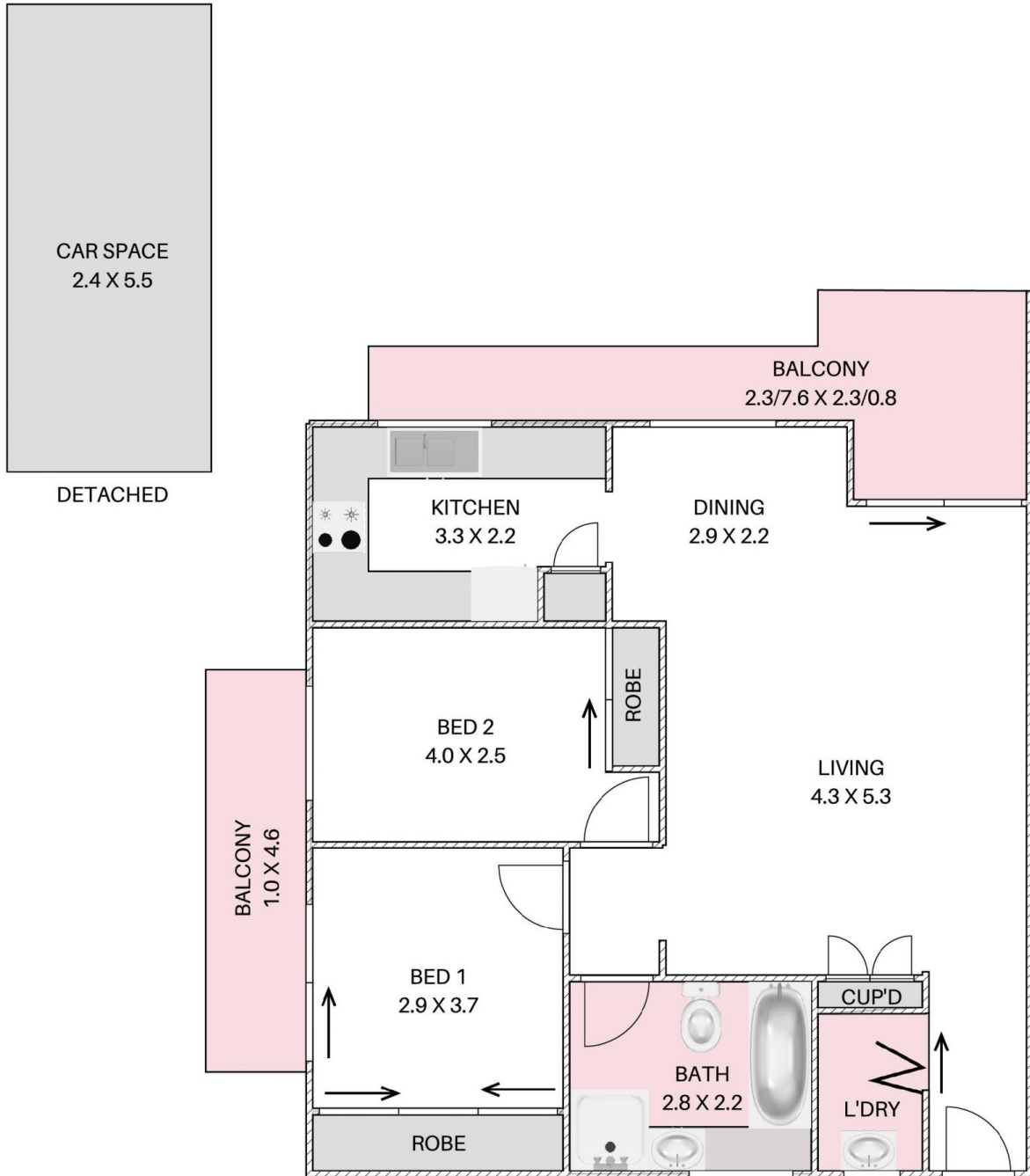

HOUSE TOTAL AREA 89.5m²

Plans shown are for presentation purposes and are not part of any legal document. Dimensions are approximate.

