



6/8 Smith Street Wollongong NSW

3  2  2 

what you will love?

space | harbour | convenience | lifestyle

Located in the Belmore Basin precinct in one of the most popular and tightly held complexes 'North Bay'. Almost house-sized proportions dominate the appeal of the northeast facing sun-drenched apartment. Known for its abundance of open space and proximity to beaches and cafes this convenient apartment is sure to suit a range of buyers.

- + updated throughout with fresh blackbutt flooring and colour schemes
- + north east facing with a large kitchen and open plan living

[For full version visit the website](#)

Type : Apartment

Price : \$ 1,440,000

View : <https://www.mcneice.com.au/8484196>



Danny Peterson
02 4284 8536

6/8 SMITH STREET, WOLLONGONG

+ molenaar
mcneice

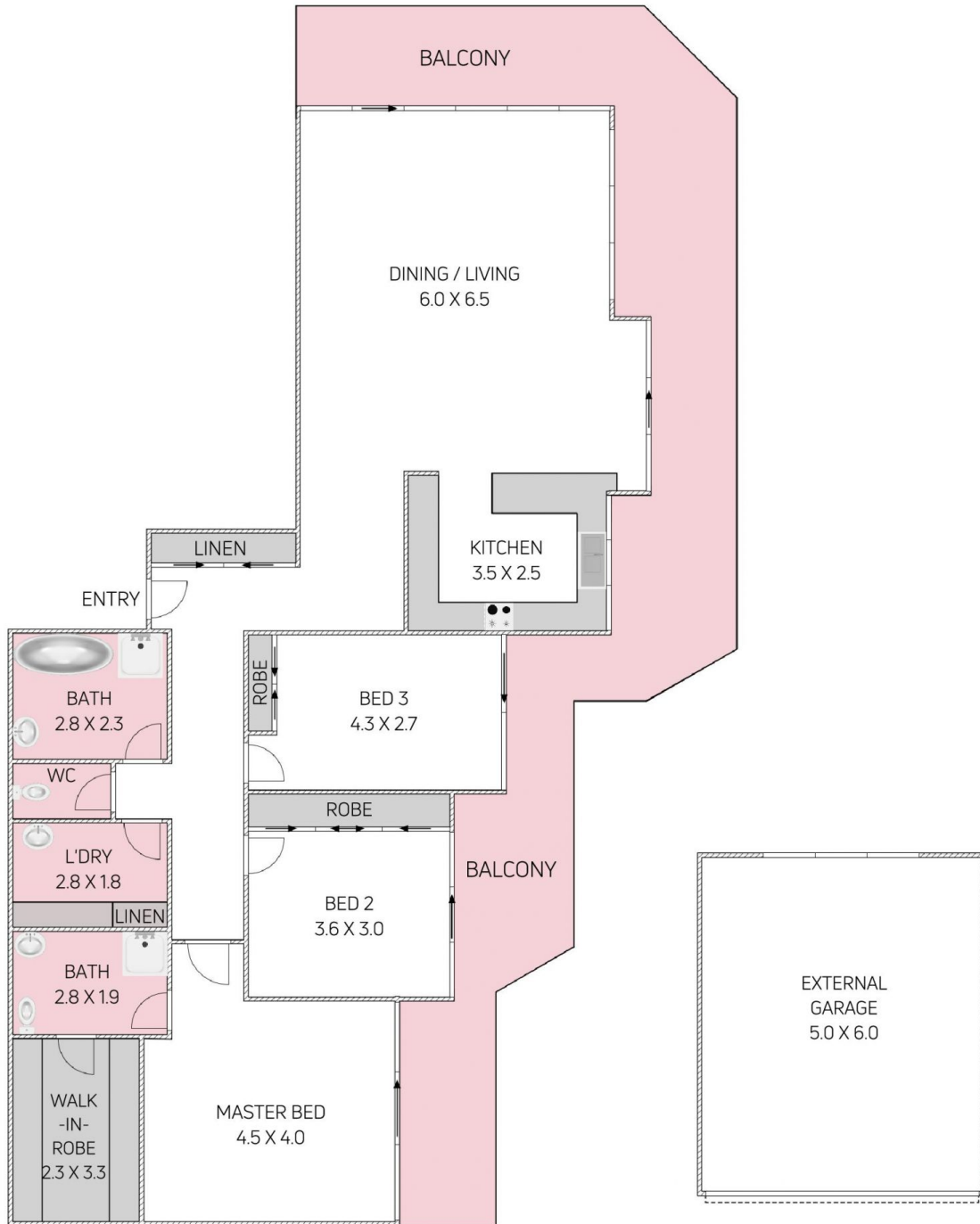

TOTAL LIVING AREA:
231 M²

Plans shown are for presentation purposes and are not part of any legal document. Dimensions are approximate.

