



406 Northcliffe Drive Berkeley NSW

3 2 1

what you will love?

sun-drenched | potential | lake | lifestyle

Set in a central position only moments from the lake, this neat three-bedroom home is the perfect starting point for those seeking affordability with water views. The family-friendly layout offers a sun-drenched lounge, dedicated dining to kitchen and a spacious low-maintenance yard. Further scope is on offer (S.T.C.A) with a 19m frontage (approx.).

- + three-bedroom clad home with loads of potential
- + open plan kitchen featuring eat-in dining room
- + desirable views across the water never to be built out

[For full version visit the website](https://www.mcneice.com.au/8484169)

Type : House
Price : \$ 600,000
Land Size : 611 sqm
View : <https://www.mcneice.com.au/8484169>



Danny Peterson
02 4284 8536

406 NORTHCLIFFE DRIVE, BERKELEY

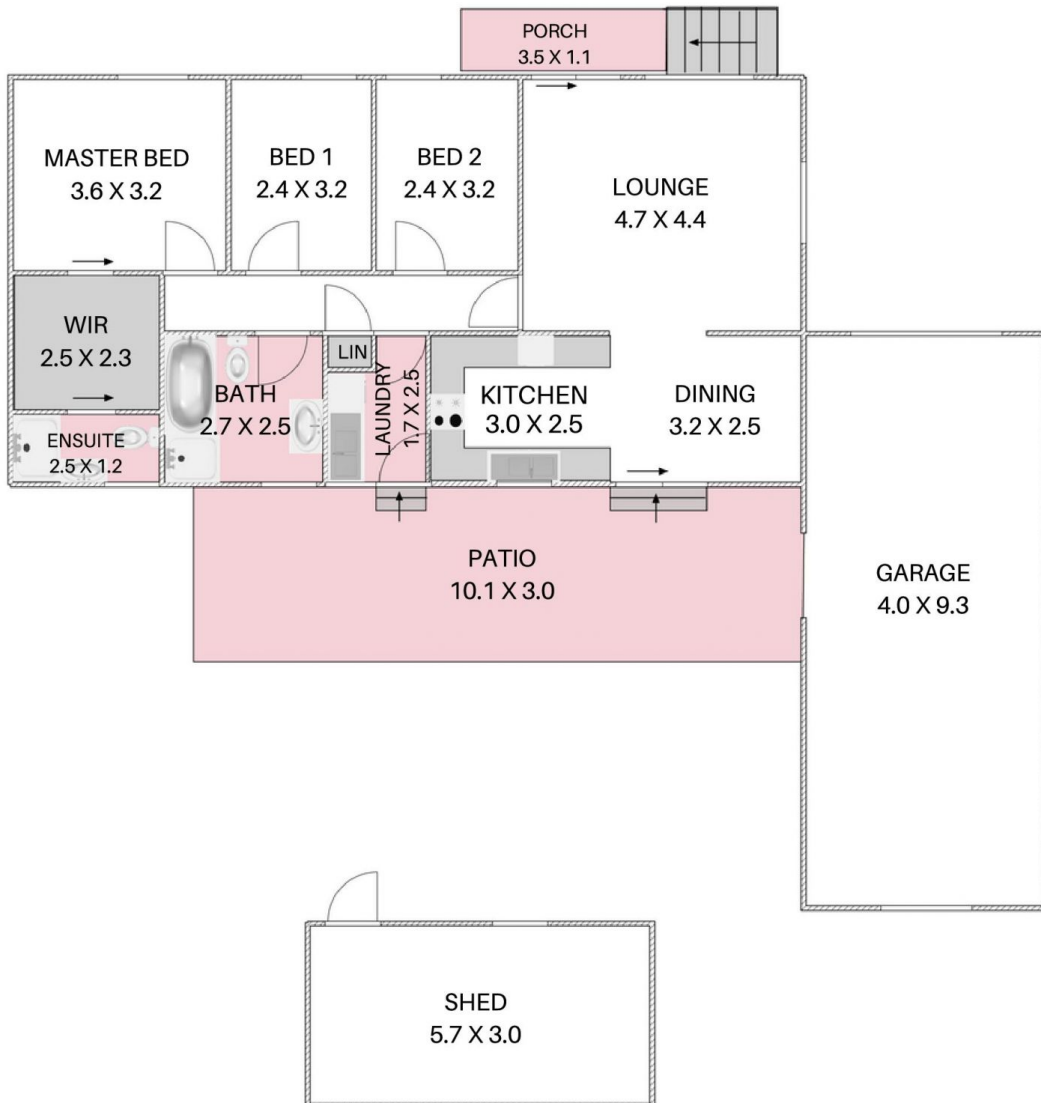

HOUSE TOTAL AREA
176.7m²



Plans shown are for presentation purposes and are not part of any legal document. Dimensions are approximate.