



## 57 Huxley Drive Horsley NSW

3 1 2

what you will love?

family | opportunity | affordable | fresh

A focus on generous interiors is apparent with a fresh and neat appearance with the perfect opportunity to acquire a smart investment or first home. Watch the kids play in the sunny level yard while entertaining friends in the outdoor pergola.

- + solid and easy to maintain brick and tile family home
- + located across the road from children's playground
- + modern kitchen with stainless steel appliances, ample bench space
- + three good-sized bedrooms with built-in wardrobes,

[For full version visit the website](https://www.mcneice.com.au)

**Type** : House  
**Price** : \$ 575,000  
**Land Size** : 589 sqm  
**View** : <https://www.mcneice.com.au/8484162>



**Danny Peterson**  
02 4284 8536

57 HUXLEY DRIVE, HORSLEY

+ molenaar  
mcneice

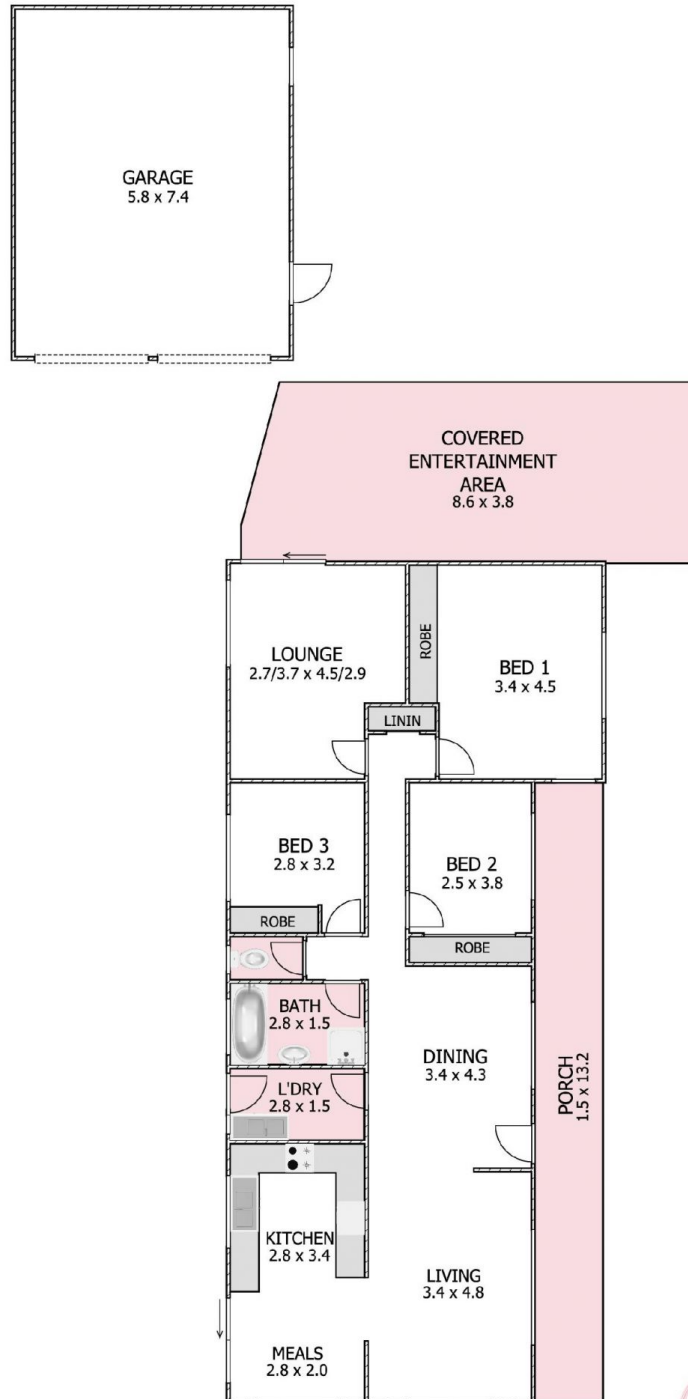

HOUSE TOTAL AREA  
216m<sup>2</sup>



Plans shown are for presentation purposes and are not part of any legal document. Dimensions are approximate.