



58 Gipps Street Wollongong NSW

4 3 2

what you will love?

spacious | location | invest | family

Situated within perfect proximity to both the CBD and the beautiful harbour, this generous double storey home offers a superb opportunity to reside or undeniable capacity for a prime investment. The elevated outlook captures northern light, mountain views and is only footsteps to everything.

- + spacious floor plan, highly desirable for growing families
- + the perfect option for combined family or dual living/investment
- + extensive living on both levels or dedicated independent home office

[For full version visit the website](https://www.mcneice.com.au)

Type : House
Price : \$ 1,215,000
Land Size : 398 sqm
View : <https://www.mcneice.com.au/8484130>



Danny Peterson
02 4284 8536



Daniel Mulholland
02 4284 8536

58 GIPPS STREET, WOLLONGONG

+ molenaar
mcneice

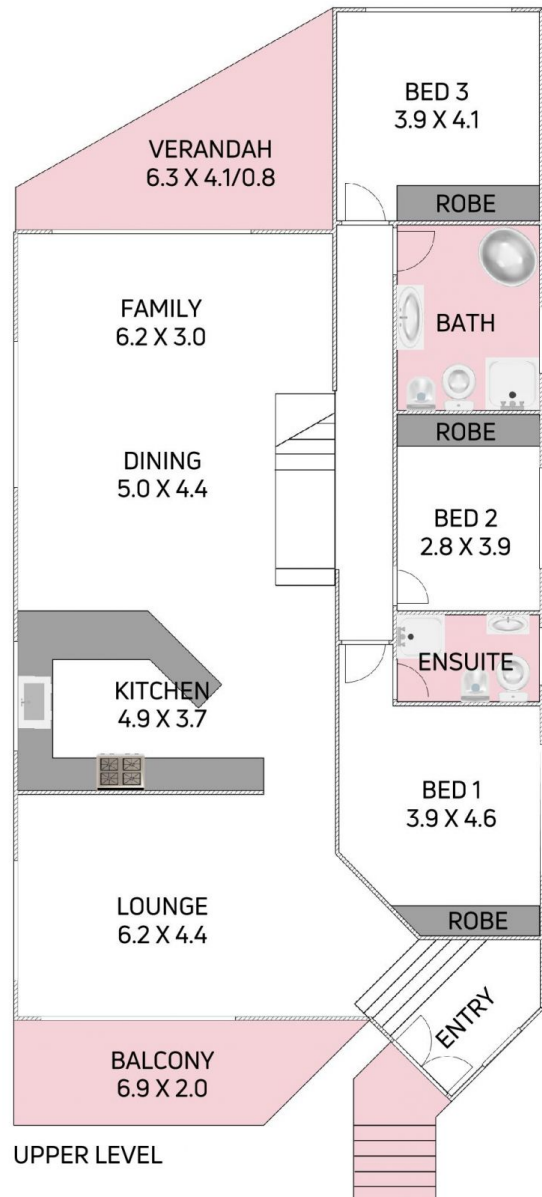
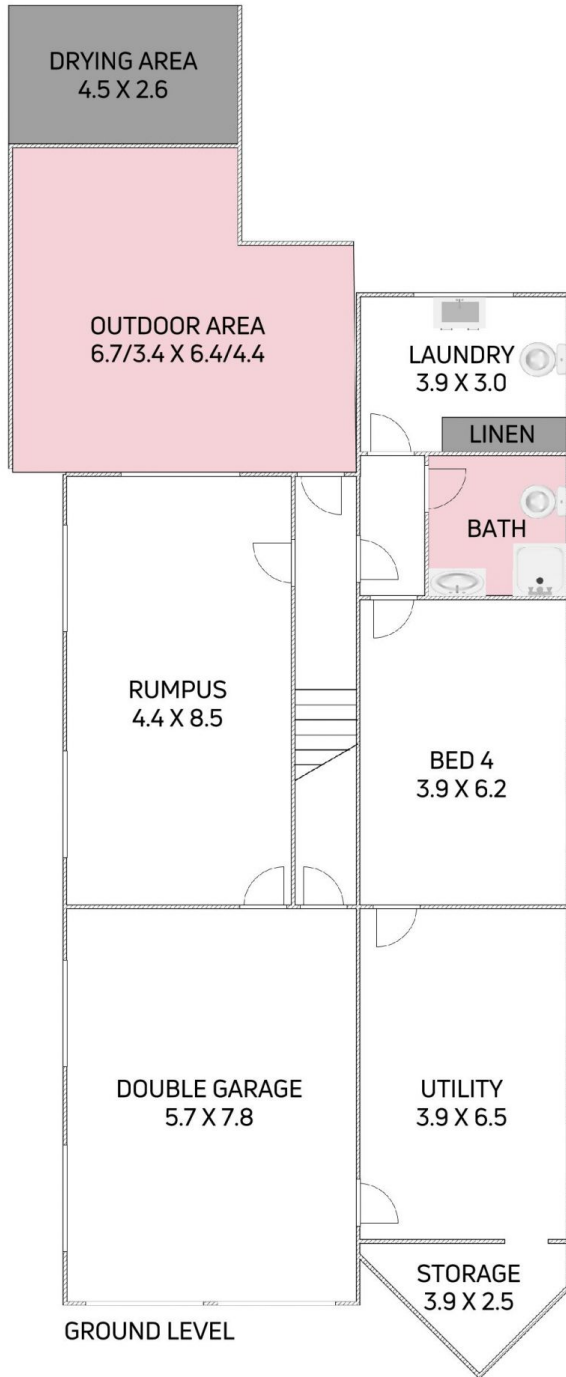

Plans shown are for presentation purposes and are not part of any legal document. Dimensions are approximate.

