



12 Heeterra Place Cordeaux Heights NSW

5 2 3

what you will love?
family | space | level | aspect

Peace, privacy and flexible living are just a few of the enticing qualities at the heart of this family home. Set on almost 870sqm, you will love the community and family-oriented neighbourhood but most of all this quiet cul-de-sac is just a short stroll to local cafes and eateries. This unique home delivers spacious renovated interiors and multiple indoor/outdoor entertaining options, including a sparkling in-ground pool.

+ tastefully updated throughout with a fresh colour palette
+ four bedrooms of accommodation plus a study/fifth

[For full version visit the website](https://www.mcneice.com.au)

Type : House
Land Size : 864 sqm
View : <https://www.mcneice.com.au/8484048>



Daniel Mulholland
02 4284 8536



Danny Peterson
02 4284 8536

12 HEETERRA PLACE, CORDEAUX HEIGHTS

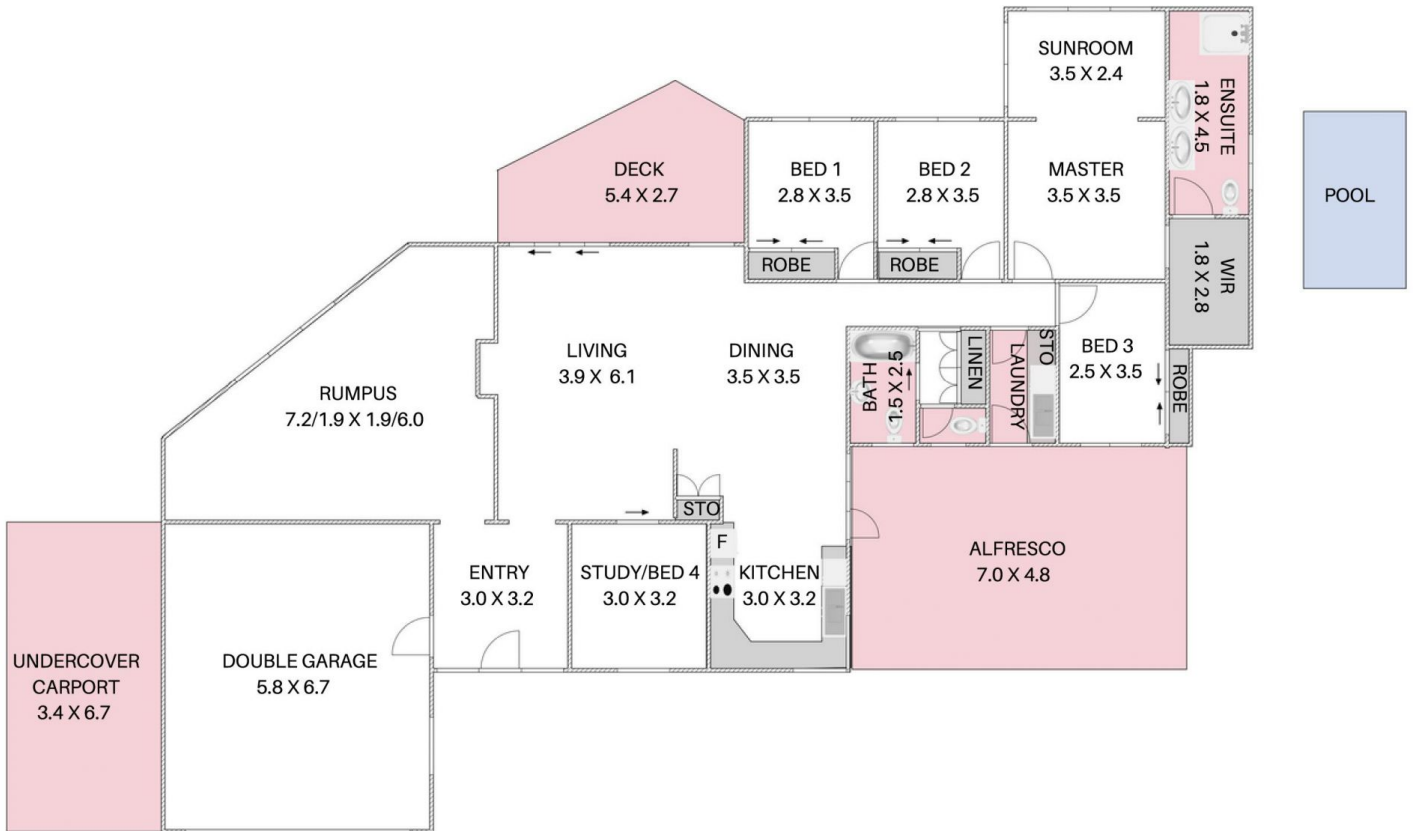

HOUSE TOTAL AREA
295.5 m²



Plans shown are for presentation purposes and are not part of any legal document. Dimensions are approximate.