



7 Wilford Street Corrimal NSW

3 1 1

what you will love?

entertainer | space | position | affordability

Set on a great level block with rear lane access, this open plan home is practical yet extremely functional. Outside entertaining is well catered for with a private enclosed deck, perfect for summertime enjoyment with family and friends.

- + highly desirable location, short walk to all amenities
- + three generous sized bedrooms, two living areas
- + updated kitchen, generous bench space and open dining
- + large rear entertainers' deck with bar overlooks yard
- + tradesmen/car enthusiasts will love the 4.2 x 8.9 m

[For full version visit the website](https://www.mcneice.com.au)

Type : House
Price : \$ 725,000
Land Size : 576 sqm
View : <https://www.mcneice.com.au/8483960>



Danny Peterson
02 4284 8536

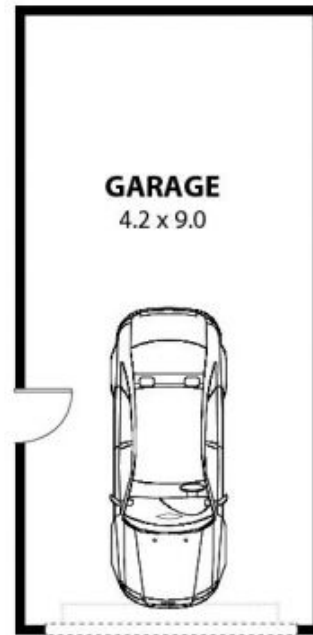
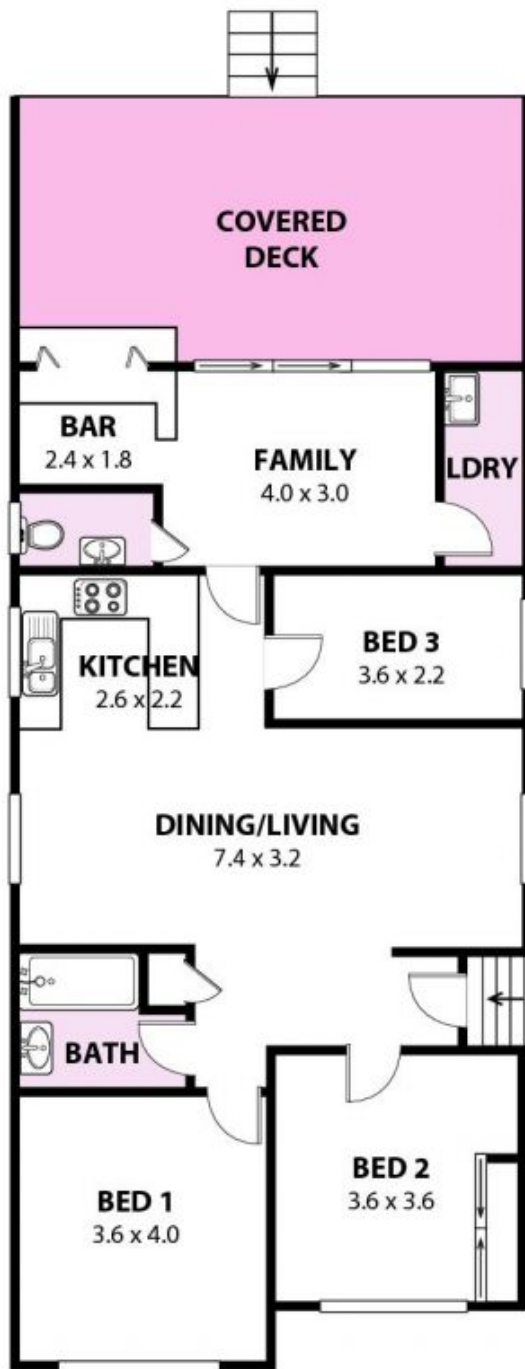

7 Wilford Street Corrimal

INTERNAL SPACE 138m² (approx)

Plans shown are for presentation purposes and are not part of any legal document or title and are subject to errors, omissions, inaccuracies and should not be used as sole and accurate reference. Particulars given are for general information only and do not constitute any representation on the part of the vendor or agent. No liability will be accepted.

AR2