



## 25 Billabong Avenue Dapto NSW

3 1 1

affordable | convenient | starter

Peacefully tucked away in a great street with easy side access to the rear, on a generous sized block, this neat three-bedroom home enjoys convenience to all amenities such as shops, public transport, cafes, Dapto medical centre, M1 motorway and more. This is a great opportunity for first home buyers entering into the market or those in need of wheel chair access due to the accommodating floor plan.

what you will love...

> generous sized living with a split system air conditioner

[For full version visit the website](https://www.mcneice.com.au)

**Type** : House  
**Price** : \$ 731,000  
**Land Size** : 556 sqm  
**View** : <https://www.mcneice.com.au/8483107>

25 Billabong Avenue,  
Dapto

molenaar × mcneice

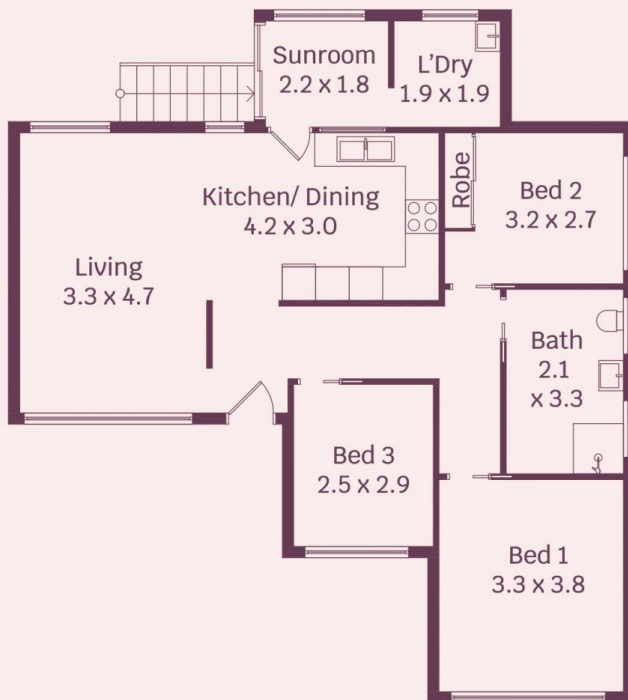
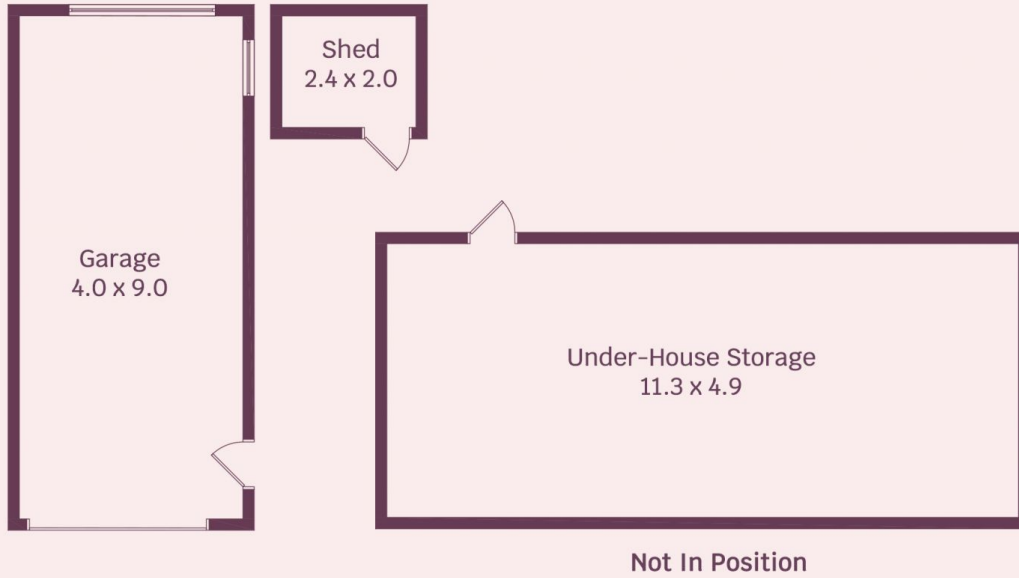

HOUSE INTERNAL AREA 95m<sup>2</sup>  
HOUSE OVERALL AREA 207m<sup>2</sup>

Plans shown are for presentation purposes and  
are not part of any legal document.  
Dimensions are approximate