



8 Heeterra Place Cordeaux Heights NSW

3 2 2

entertainer | space | comfort

Escape to tranquility in this stunning split-level home, perfectly situated in a peaceful cul-de-sac surrounded by lush greenery and trees. This home is more than just a house; it's a serene sanctuary where you can unwind and enjoy life.

what you will love...

- > versatile split-level design maximising space and functionality, making this home perfect for families or anyone seeking flexibility
- > multiple outdoor living spaces including two outdoor

[For full version visit the website](https://www.mcneice.com.au/8483102)

Type : House
Price : \$ 1,100,000
Land Size : 664 sqm
View : <https://www.mcneice.com.au/8483102>

8 Heeterra Place
Cordeaux Heights

molenaar × mcneice

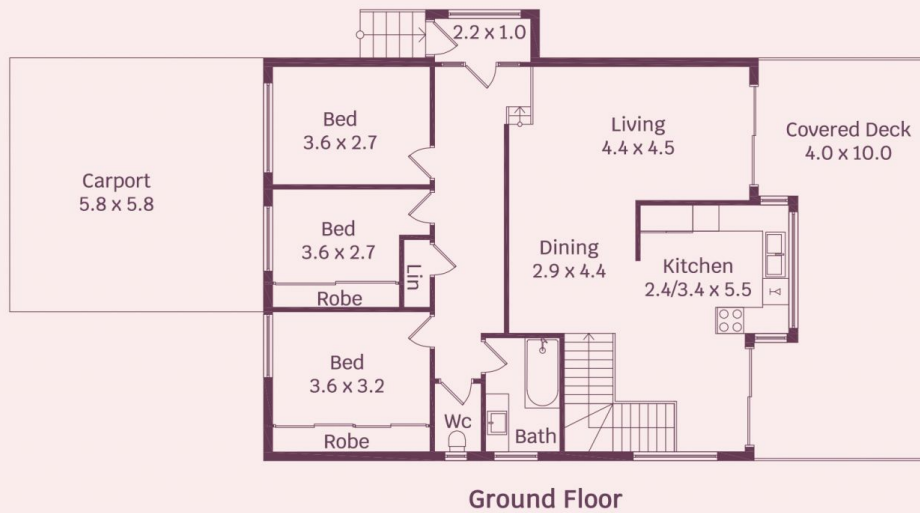

HOUSE INTERNAL AREA 225m²
HOUSE OVERALL AREA 450m²

Plans shown are for presentation purposes and
are not part of any legal document.
Dimensions are approximate