

23 Pooraka Avenue West Wollongong NSW

3  2  2 

When pure convenience, quality, picturesque escarpment views and a family friendly suburb intertwine, you'll get this stunning blend of family living. Set in an elevated position, overlooking Mt Keira in one of the Illawarra's most prestigious suburbs, is this fully renovated, 3 bedroom family home which offers quality throughout.

Type : House
Building Size : 12 sqm
Land Size : 740 sqm
View : <https://www.mcneice.com.au/8483027>

It's close proximity to parks, Figtree Grove shopping centre, good schools, Wollongong University, sporting ovals, easy access to the M1 motorway & Wollongong CBD, makes this home a true stand out option for all home buyers.

From the polished blackbutt timber floors, stunning kitchen, integrated smart ducted reverse cycle air conditioning

[For full version visit the website](#)

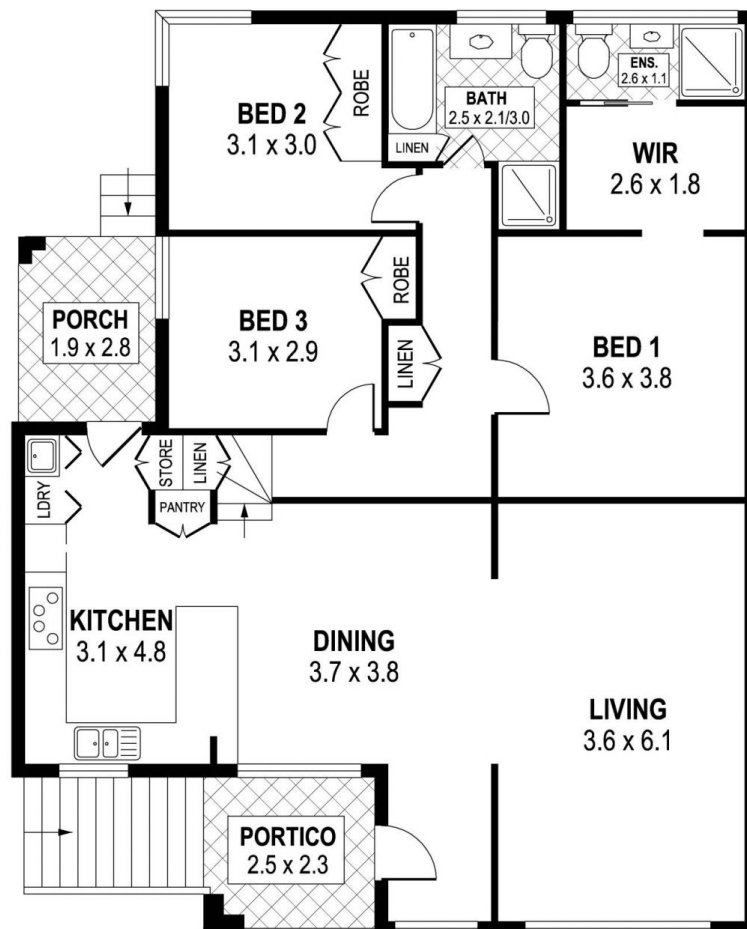
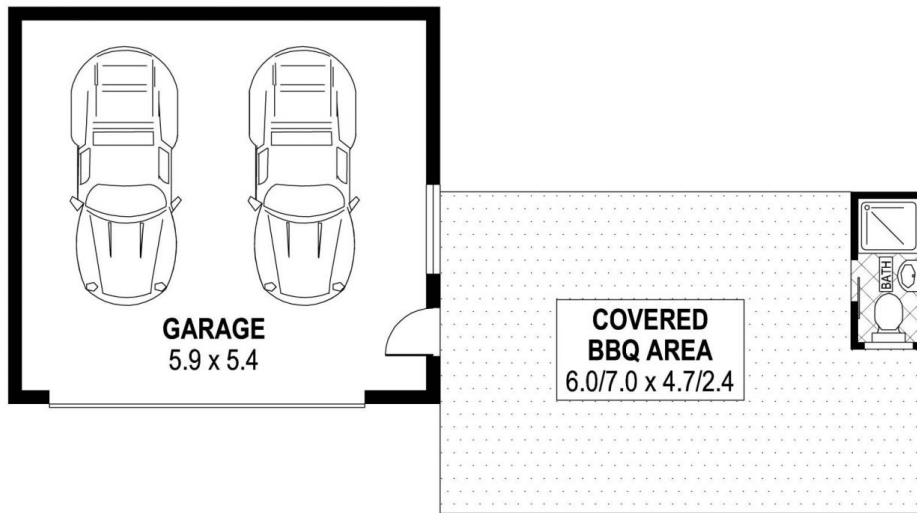

PLANS SHOWN ONLY INDICATIVE OF LAYOUT. DIMENSIONS ARE APPROXIMATE.

INT : 113m²
EXT : 11m²
GARAGE : 32m²
COVERED BBQ AREA : 31m²

23 POORAKA AVENUE

WEST WOLLONGONG

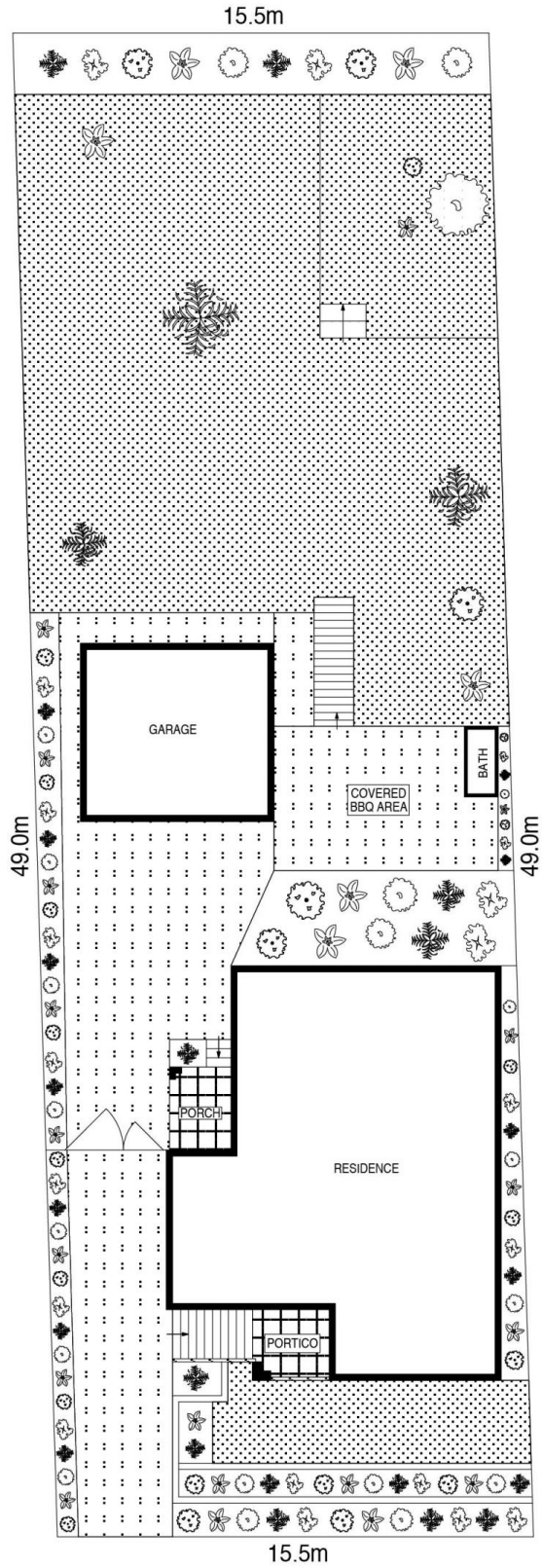

SITE PLAN



SCALE (METRES)

PLANS SHOWN ONLY INDICATIVE OF LAYOUT. DIMENSIONS ARE APPROXIMATE.
Ref. No: 90537

23 POORAKA AVENUE

WEST WOLLONGONG