



3/26 Avondale Road Avondale NSW

3 1 2

A modern townhouse set in the ideal location. Easy access to the M1 northbound entry and to the Princes Highway in both directions. Living here provides a modern convenient and low maintenance lifestyle perfect for the first homeowner or investor.

Type : Townhouse

Price : \$ 565,000

View : <https://www.mcneice.com.au/8483011>

The property is ideal for first homeowners or investors. The best time to enter the market to take advantage of the current stamp duty savings! The property is currently tenanted, however, vacant possession can be made available.

The Main Features:

[For full version visit the website](#)

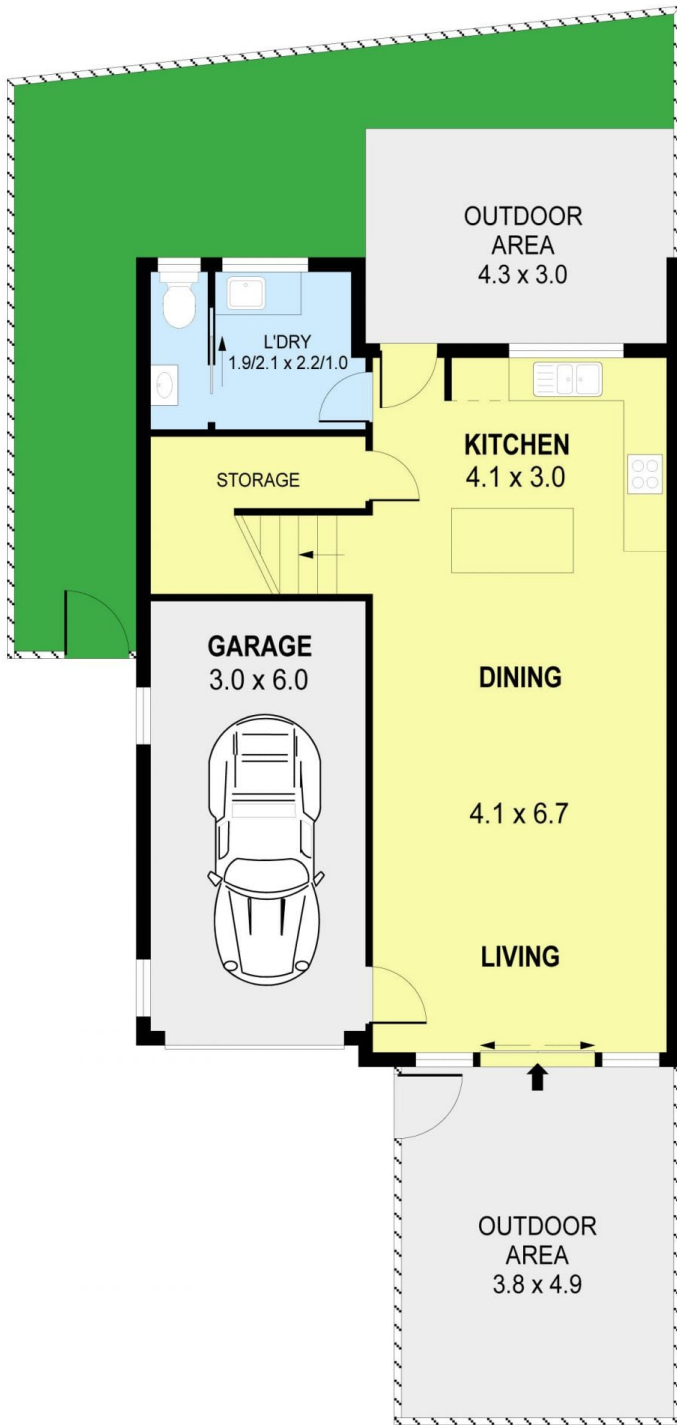

GROUND LEVEL

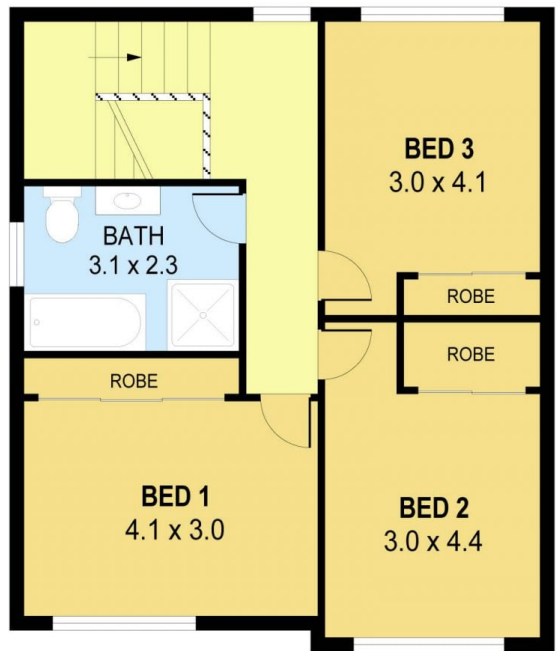

UPPER LEVEL



PLANS SHOWN ONLY INDICATIVE OF LAYOUT. DIMENSIONS ARE APPROXIMATE.
Ref. No. 49550

INT : 114m²
EXT : 60m²
GARAGE: 18m²

UNIT 3, 26 AVONDALE ROAD

AVONDALE