

2/173-175 Wentworth Street Port Kembla NSW

2 1 1

A cracking 2 bedroom unit perched on the high side of the street, this first floor unit boasts privacy, space and potential. East facing, the two bedrooms are the ideal orientation for the morning sun accompanied with plenty of storage.

**Type** : Apartment

**Price** : \$ 370,000

**View** : <https://www.mcneice.com.au/8483010>

The Main Features:

- 2 spacious bedrooms both with built in wardrobes
- Large modern open plan kitchen, living and meals area
- Under car space with rear lane access
- Large bathroom with functional layout

The Real Benefits:

[For full version visit the website](#)

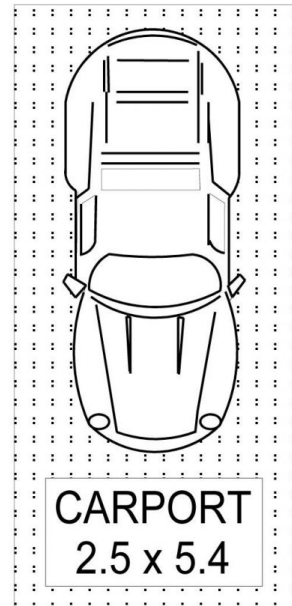
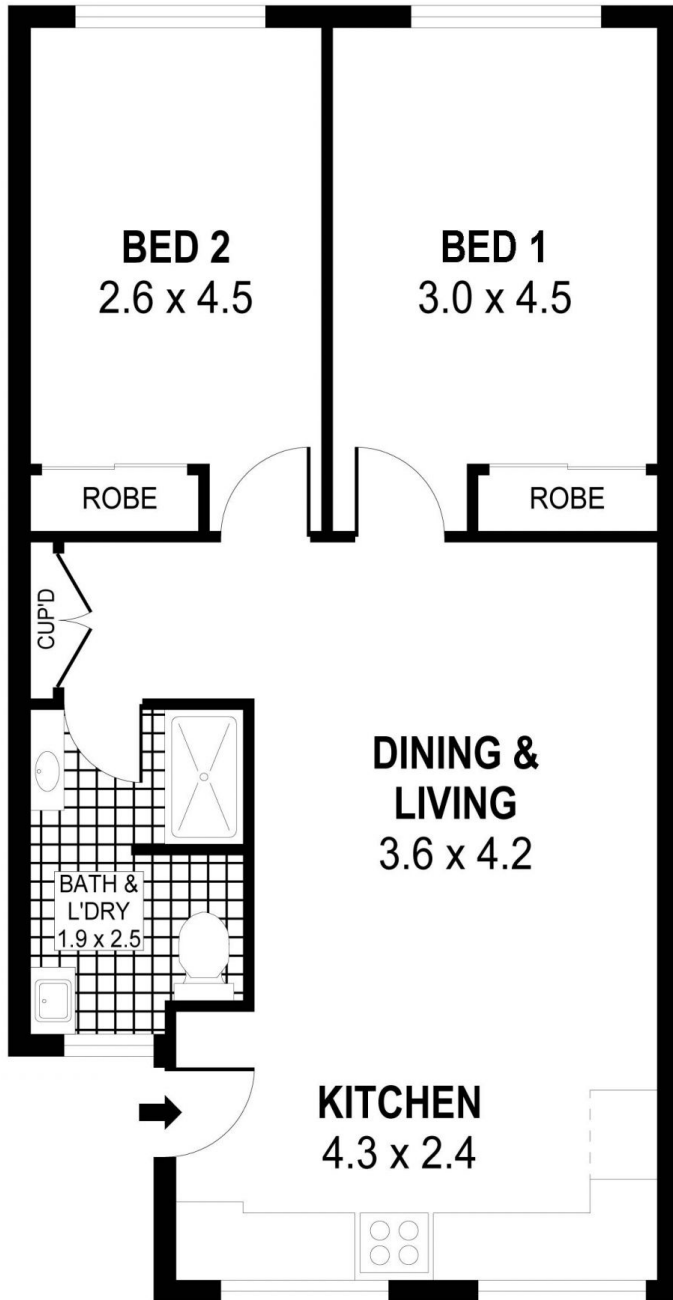

DETACHED



PLANS SHOWN ONLY INDICATIVE OF LAYOUT. DIMENSIONS ARE APPROXIMATE.  
Ref. No: 88822

INT : 60m<sup>2</sup>  
CARPORT : 14m<sup>2</sup>

UNIT 2, 173-175 WENTWORTH STREET

PORT KEMBLA