



## 9 Parkdale Avenue Horsley NSW

4 2 3

Here at 9 Parkdale Avenue Horsley sits a home that really is different in a very, very good way. The functional family layout accompanied with the space both inside and out really is the ideal equation for your family home. The added extras here are second to none and a rare find in today's market.

**Type** : House  
**Price** : \$ 690,000  
**Land Size** : 781.5 sqm  
**View** : <https://www.mcneice.com.au/8482995>

### The Main Features:

- 4 spacious bedrooms, master suite with triple built in wardrobes and ensuite
- Large chefs style kitchen with dual oven and plenty of storage
- 2 separate living areas accompanied by 2 separate meals

[For full version visit the website](https://www.mcneice.com.au)

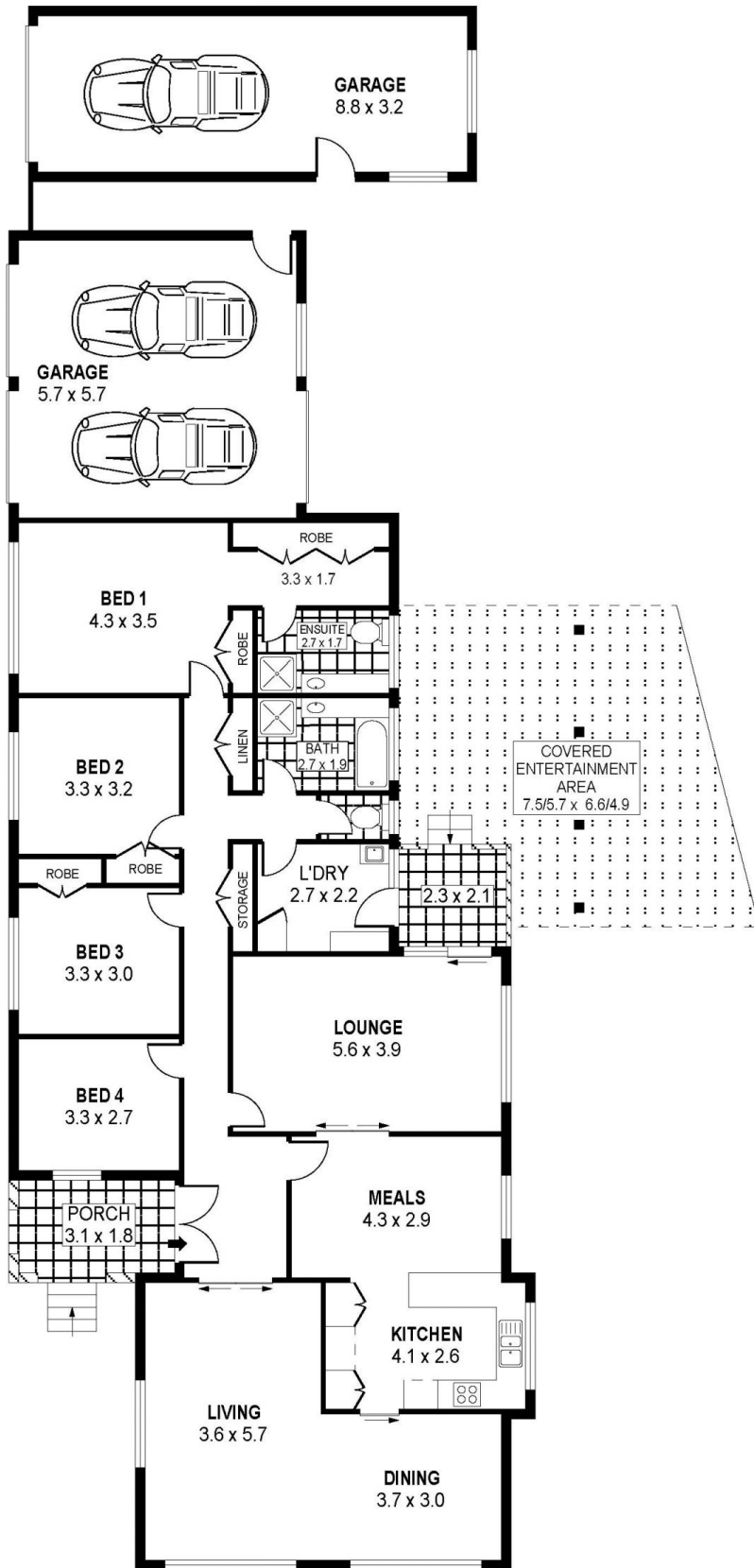

SCALE (METRES)

PLANS SHOWN ONLY INDICATIVE OF LAYOUT. DIMENSIONS ARE APPROXIMATE.  
Ref. No: 71009

INT : 169m<sup>2</sup>  
EXT : 50m<sup>2</sup>  
GARAGES : 61m<sup>2</sup>

9 PARKDALE AVENUE

HORSLEY

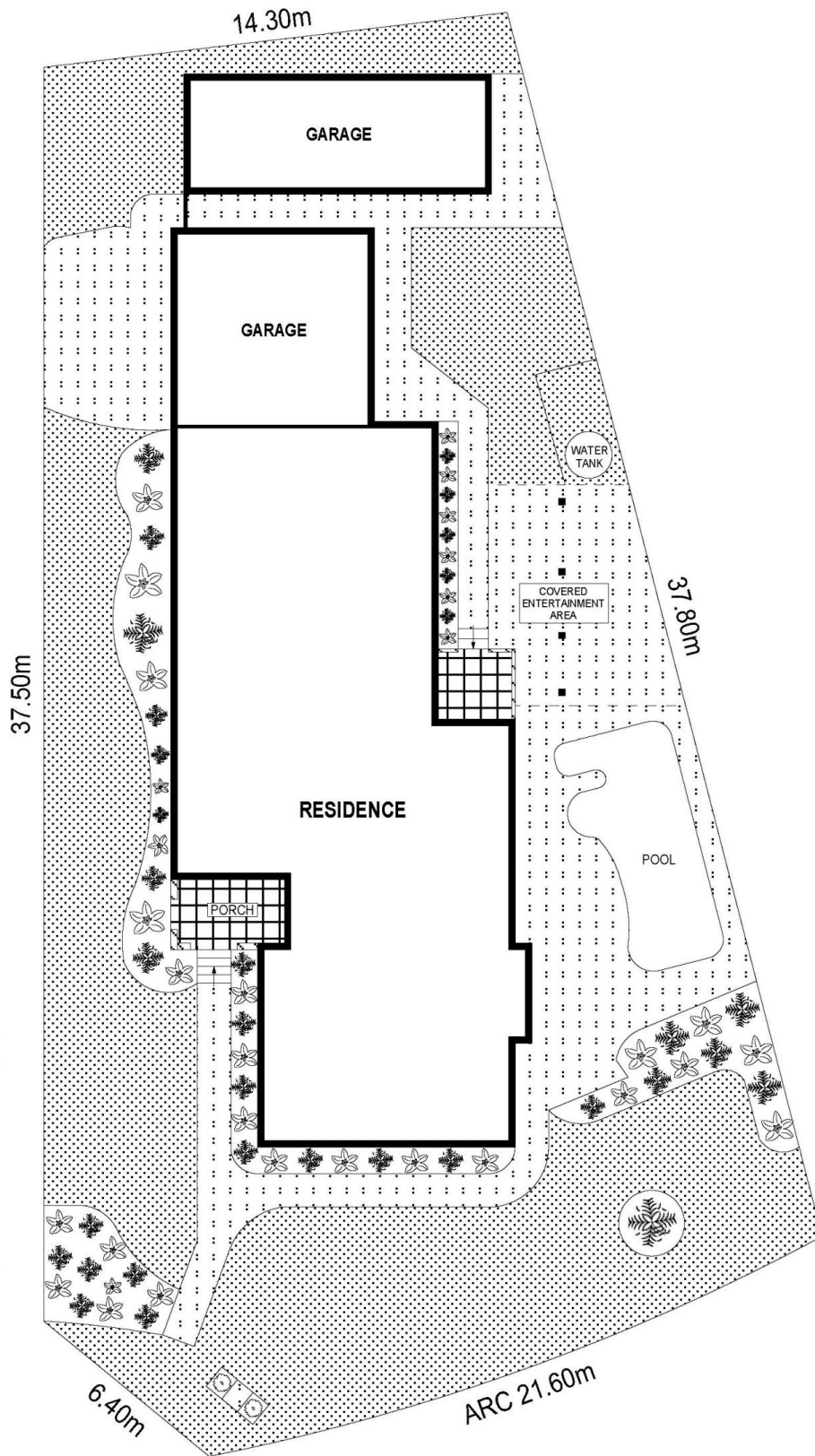

**SITE PLAN**



**SCALE (METRES)**

PLANS SHOWN ONLY INDICATIVE OF LAYOUT. DIMENSIONS ARE APPROXIMATE.  
Ref. No: 71009

**9 PARKDALE AVENUE**

**HORSLEY**