



11 Madoline Street Gwynneville NSW

2  1  1 

Set on a 525m² block is an updated 2-bedroom home located in Gwynneville's most sort after locations. This home presents a rare opportunity to renovate, extend or rebuild. The home provides much more than high ceilings, large spaces, light interiors & antique charm. It offers the ideal location and endless possibilities.

Type : House
Land Size : 525 sqm
View : <https://www.mcneice.com.au/8482959>

The Main Features:

- 2 spacious bedrooms with high ceilings
- Huge lounge room with loads of natural light
- Large level block with plenty of scope to expand
- Single carport offering side access into the backyard
- Directly opposite the University of Wollongong and the

[For full version visit the website](https://www.mcneice.com.au)

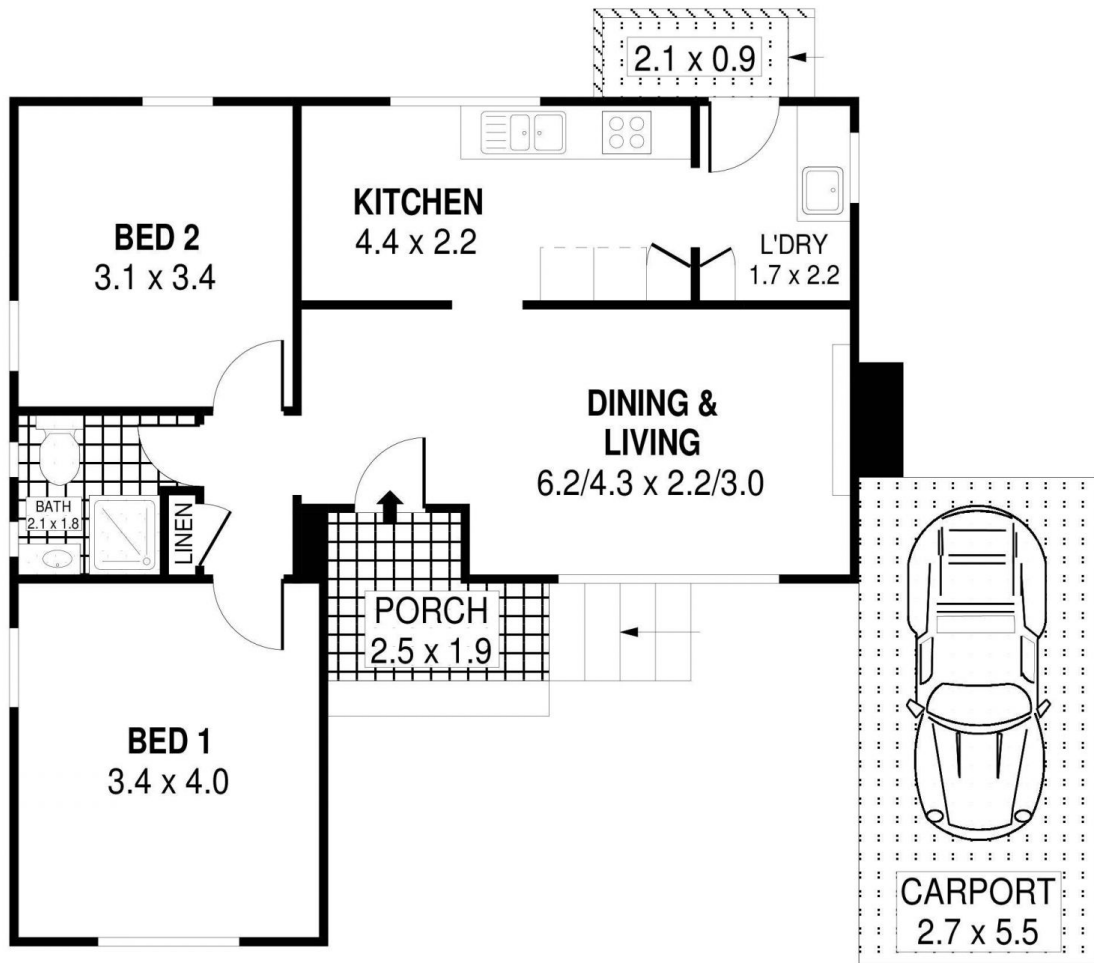

PLANS SHOWN ONLY INDICATIVE OF LAYOUT. DIMENSIONS ARE APPROXIMATE.
Ref. No: 100871

INT : 62m²
EXT : 6m²
CARPORT : 15m²

11 MADOLINE STREET

GWYNNEVILLE

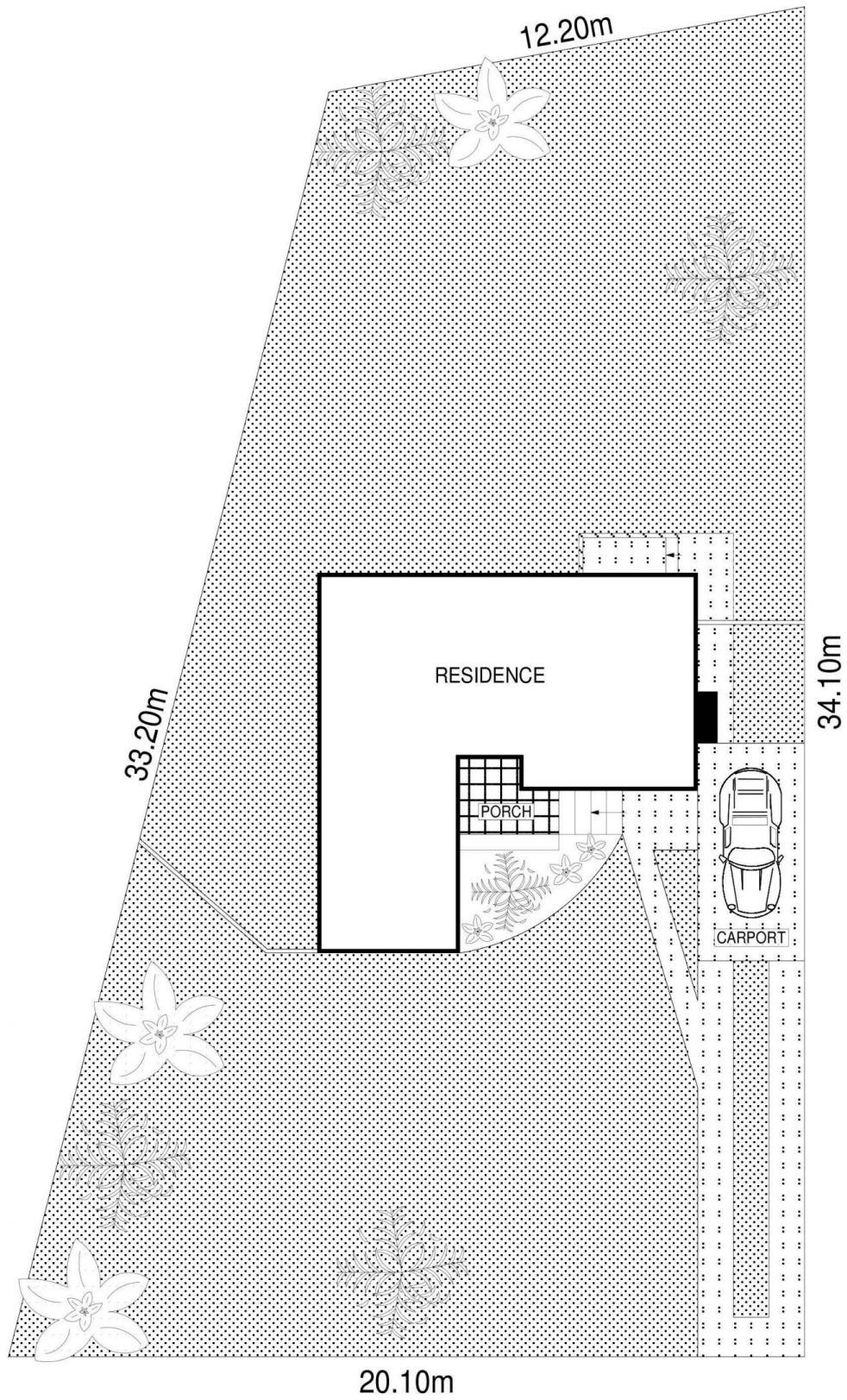

SITE PLAN

PLANS SHOWN ONLY INDICATIVE OF LAYOUT. DIMENSIONS ARE APPROXIMATE.
 Ref. No: 100871

11 MADOLINE STREET

GWYNNEVILLE