



25 Hopewood Crescent Fairy Meadow NSW

3 1 4

Peacefully tucked away in an incredibly attractive tree-lined street, is this immaculate, single level, 3 bedroom brick veneer home which is spread over 594.4m² of land and offers families a great opportunity to enjoy the fantastic northern suburbs lifestyle.

Type : House
Price : \$ 1,055,000
Land Size : 594.4 sqm
View : <https://www.mcneice.com.au/8482952>

Whilst the practical floor plan caters to those looking for space, the triple lock up garage at the rear caters to car enthusiasts & tradies.

Offering good sized bedrooms main with built in wardrobe, neat bathroom & kitchen, two separate living areas, landscaped gardens, solar panels which provide great energy efficiency, multiple split system air conditioning

[For full version visit the website](#)

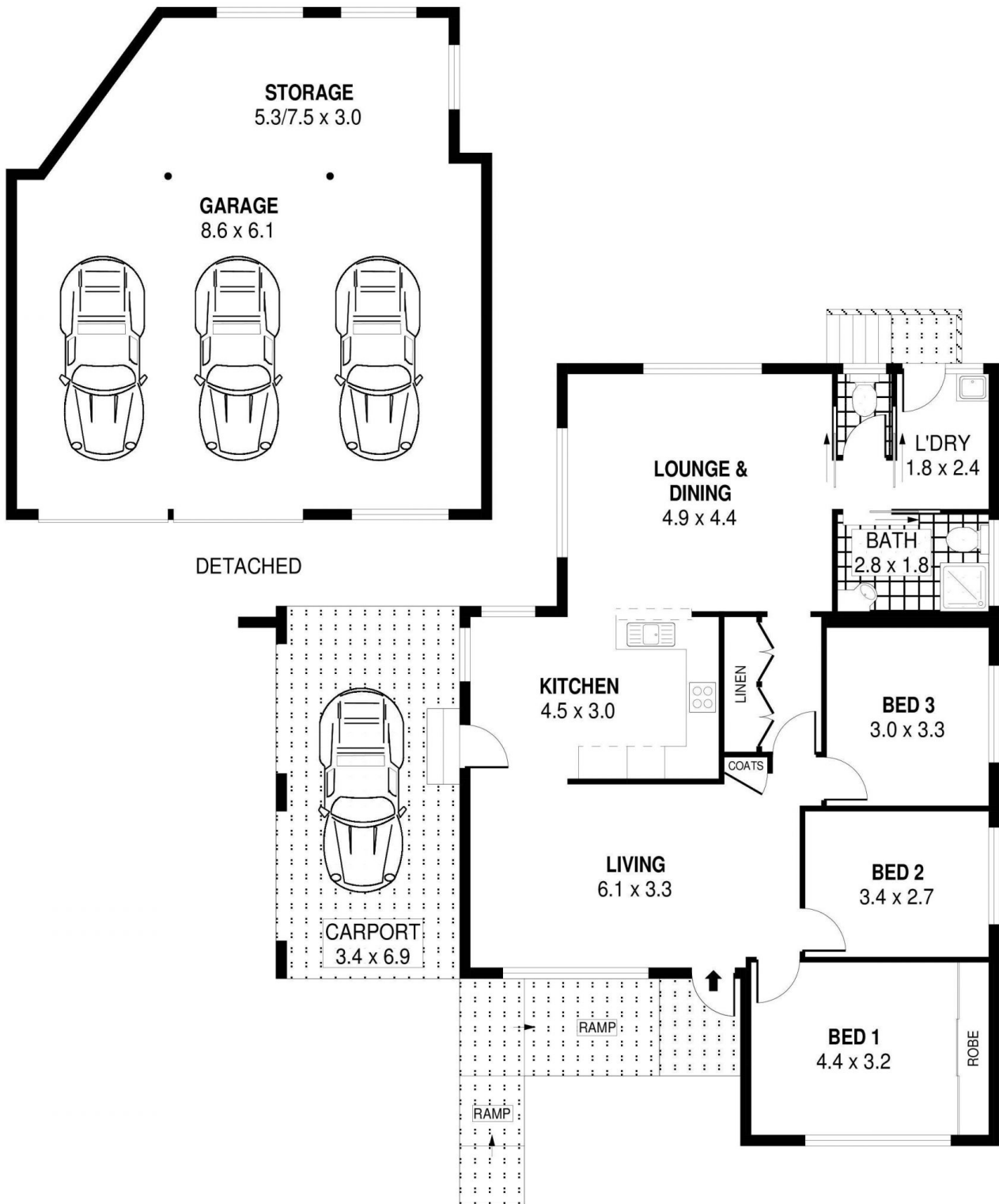

PLANS SHOWN ONLY INDICATIVE OF LAYOUT. DIMENSIONS ARE APPROXIMATE.
Ref. No: 102688

INT	: 111m ²
EXT	: 4m ²
GARAGE	: 72m ²
CARPORT	: 24m ²

25 HOPEWOOD CRESCENT

FAIRY MEADOW

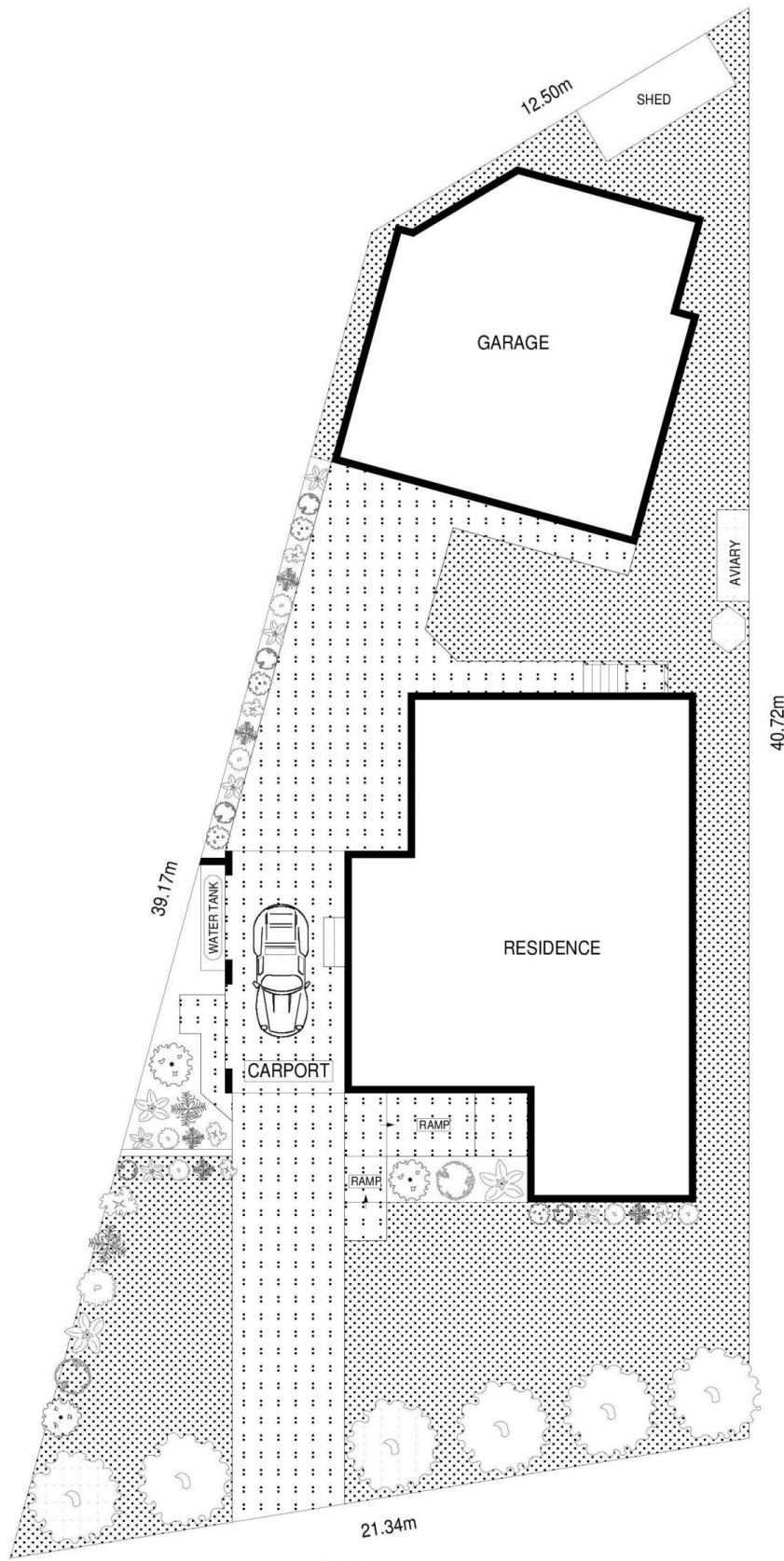

SITE PLAN

PLANS SHOWN ONLY INDICATIVE OF LAYOUT. DIMENSIONS ARE APPROXIMATE.
 Ref. No: 102688