



19 Burke Road Dapto NSW

3  1  3 

Spread over a 601m² parcel of land and situation in a convenient location, is this generously sized, 3 bedroom family home, which offers the perfect blank canvas for those looking for a renovation project or a knockdown & rebuild opportunity.

Type : House
Land Size : 601 sqm
View : <https://www.mcneice.com.au/8482922>

Offering multiple living areas, good sized bedrooms, pine timber floors, high ceilings with decorative cornices, an inground swimming pool, double lock up garage, carport/outdoor entertaining area and side access to the rear.

The Main Features:

[For full version visit the website](#)

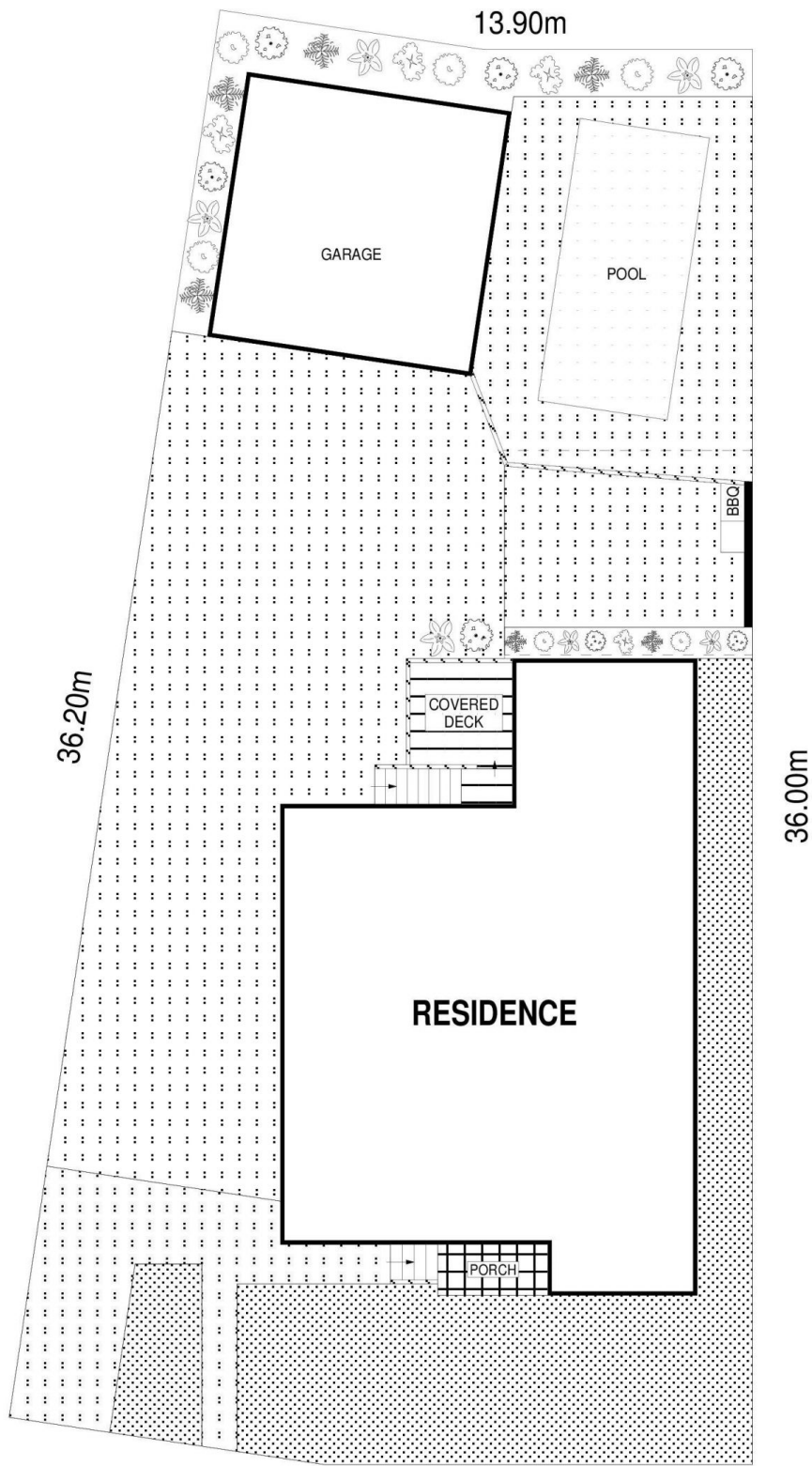

19.30m
SITE PLAN



SCALE (METRES)

PLANS SHOWN ONLY INDICATIVE OF LAYOUT. DIMENSIONS ARE APPROXIMATE.
Ref. No: 98005

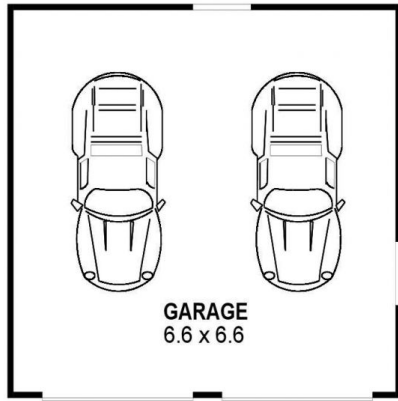

DETACHED

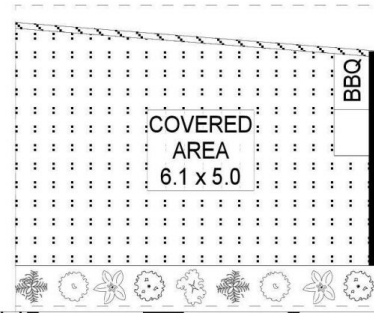

PLANS SHOWN ONLY INDICATIVE OF LAYOUT. DIMENSIONS ARE APPROXIMATE.
Ref. No: 98005

INT : 136m²
EXT : 36m²
GARAGE : 44m²

19 BURKE ROAD

DAPTO