



1/44 Keerong Avenue Russell Vale NSW

3  1  2 

Type : Townhouse

Price : \$ 705,000

View : <https://www.mcneice.com.au/8482891>

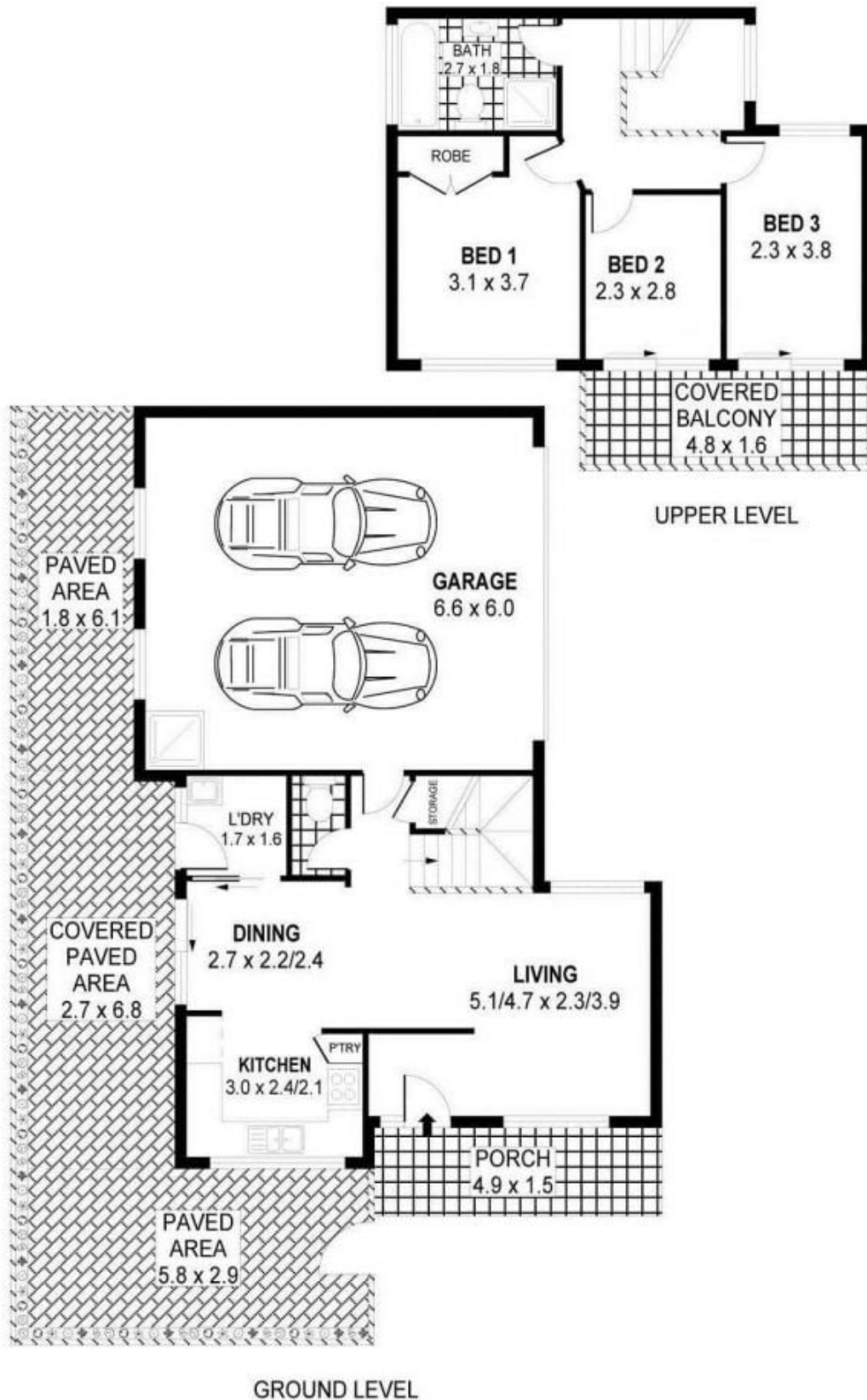

0 1 2 3 4 5
SCALE (METRES)

PLANS SHOWN ONLY INDICATIVE OF LAYOUT. DIMENSIONS ARE APPROXIMATE.
 Ref. No. 40991

INT : 86m²
 EXT : 59m²
 GARAGE : 40m²

1/44 KEERONG AVENUE

RUSSELL VALE